

RDJ TRUCKS

Make & Modle

CHEVROLET SILVERADO / GMC SIERRA 99-02

(Excluding Sport Side)

CHEVROLET SILVERADO / GMC SIERRA 03-06

CHEVROLET SILVERADO / GMC SIERRA CLASSIC 07

INSTALLATION INSTRUCTION

Item No. 10-1015-99 / 25-1015-99

PRO-OFFROAD Bolt-On Style / X-TEND Style

Parts for All Style



Parts for Different Style (optional)

Pocket-n-Bolt Style only



Pocket-n-Light Style only

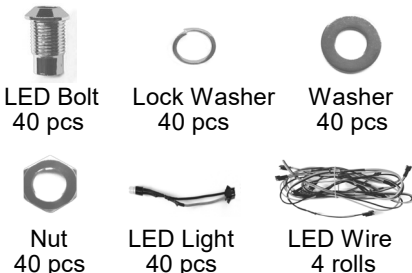

**PATENT
PRODUCT**

(9 pcs LED sets
for front flares)
(11 pcs LED sets
for rear flares)

Caution: Always check the package, ensure the fitment of fender flare and follow the instruction carefully. PSI will not be responsible for painting & other cost incurred to incorrect fender flares, failure of installation, shipping damage or modified flares.

1. Pre-Installation



1. Prefit and ensure both left (driver) side & right (passenger) side fender flare to the vehicle before painting or installation.
2. You may remove any moldings, strips or existing flares from the vehicle for fitting or installation. You can cut the fender flare to fit any body side molding also.

3. Clean Vehicle Body & Fender Flare

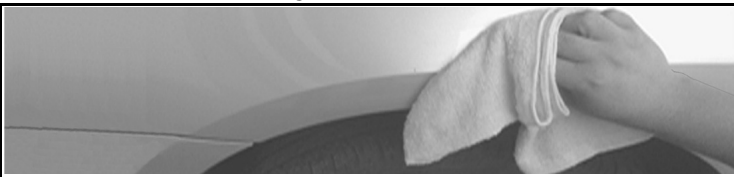

1. Wash and wipe dry the areas of contact on the vehicle body.
2. Clean the surface and inside edge of the fender flare where the rubber seal is to be attached.

5. Install Allen Bolt & Nut (for Pocket-n-Bolt Style)

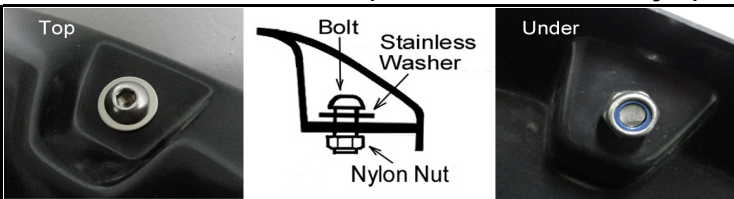

1. Use torx bit to tight allen bolt & nylon nut firmly on every pocket of the fender flares. **DO NOT OVER TIGHTEN !**
2. For Pocket-n-Bolt Style, skip 6,7,8,9 & 10, go step 11 directly.
3. For Pocket-n-Bolt with Trim Style, skip 6,7,& 8, go step 9 directly.

2. Paint Flare(Optional)

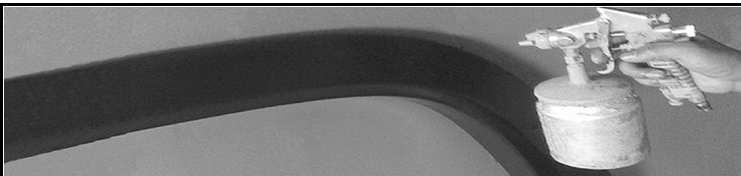

1. Hire a professional painter or body shop and follow the paint manufacturer speciifications to paint the flares.
2. Clean all fender flares surfaces with clean water and a mild detergent before paint, do not use lacquer thinner or any solvent based products.

4. Apply Rubber Seal

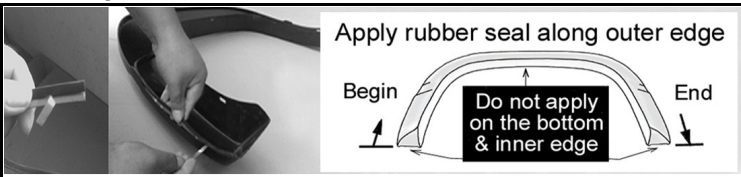

1. Remove about 1 inch tape liner from rubber seal and apply it on the flare, start one end and along the edge that comes in contact with body panel, apply pressure on the tape to ensure that it adheres well, trim excess rubber seal and so on.
2. To avoid bulge, you may cut a notch in the edge of rubber seal at the inward angle curve, cut a V out for the out ward angle curve.

6. Install LED Light (for Pocket-n-Light Style)

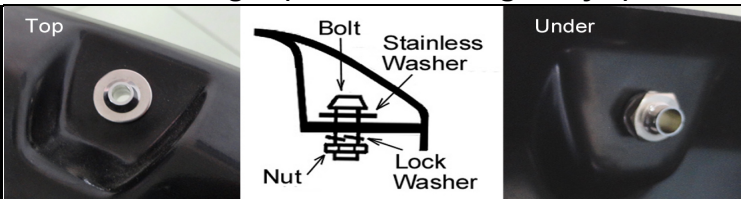

1. Tight LED Bolt, washer & nut with lock washer on every pocket of the flares. **ENSURE THE BOLTS ARE TIGHTEN ENOUGH !**
2. For Pocket-n-Light Style, ignore step 5,9 & 10, go step 11.
3. For Pocket-n-Light with Trim, ignore step 5, & follow all steps.

7. Install LED Light (for Pocket-n-Light Style)

8. Install LED Light (for Pocket-n-Light Style)

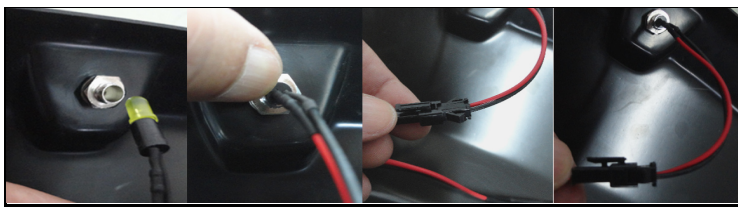

1. Insert the LED to the LED Bolt, push it into the end with nail **(see illustration). DO NOT PUSH IT WITH WIRE !**
2. To connect the connector, just push straight in the clip side on the female part and stoper side on the male part together.
3. To unplug the connector for replacement or if necessary, just push down the clip end on the female part, pinch two side wing on the male part and pull straight out the male part.
4. To disconnect the LED for replacement, just push down the LED from **top side** & take it out. **DO NOT PULL OUT WITH WIRE !**

9. Installation for All Style (Left Front Flare Shown)

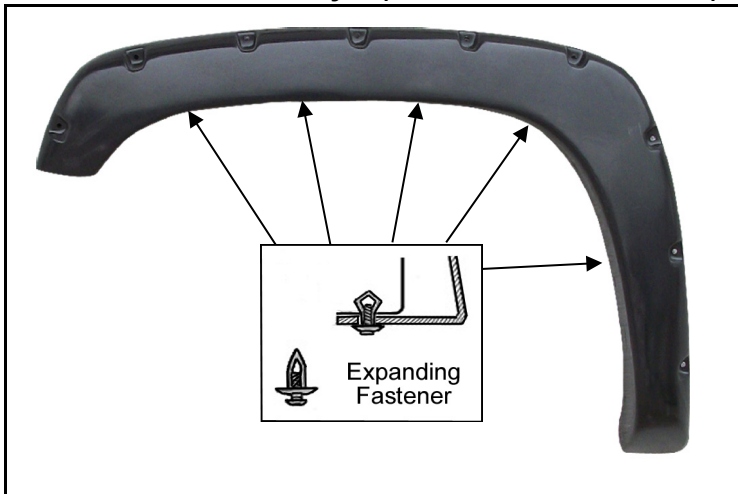

1. Place the flare on the vehicle with **best position**.
2. Apply 5 Plastic Fastener into the mounting slot in flare and secure it to the vehicle. **(see illustration)**

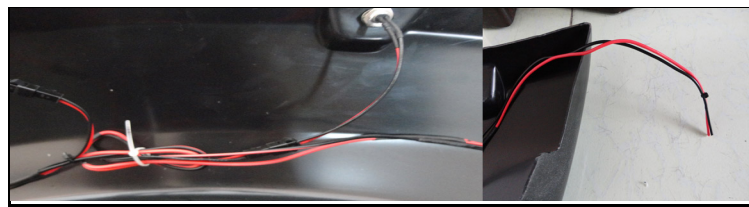

1. Tight the losing wire on the proper place.
2. The LED wire end should be toward to the front in the front flare, to the rear in the rear flare.
3. Use the extension wire **(NOT INCLUDED)** to connect LED wire and the parking light, turn signal light or orther electric source as your desire. If in doubt on the connection, get professional advice before connect it.
4. You may add a switch in between LED set and electric source to control it on and off easily.

10. Installation for All Style (Left Rear Flare Shown)

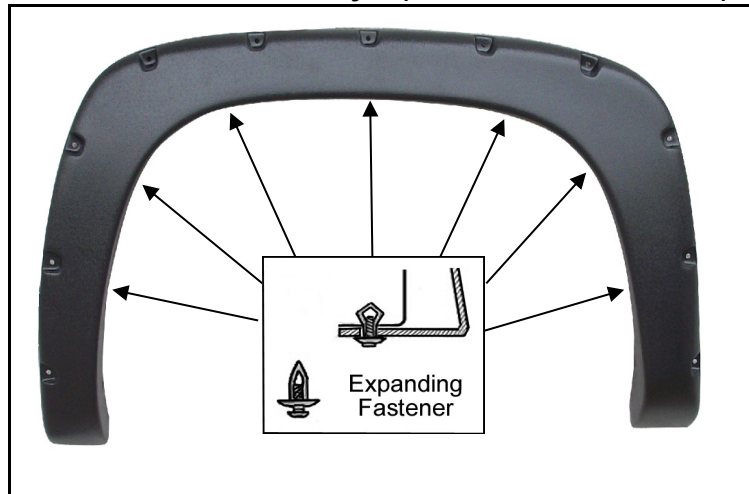

1. Place the flare on the vehicle with **best position**.
2. Apply 7 Plastic Fastener into the mounting slot in flare and secure it to the vehicle. **(see illustration)**

Optional: Use the included self tapping screw to instead of the clip, clamp or any parts where it's not workable on the different condition of the fender or it may be used for extra secure when it be needed.