

FENDER FLARE INSTALLATION INSTRUCTION

RDJ TRUCKS

Make & Model

DODGE RAM 2500/3500 2019-2024

Item No. 10-2017 / 25-2017

(2 Different Style Fender Flare Available)

PRO-OFFROAD BOLT-ON STYLE (10-2017)

PRO-X-TEND STREAMLINE SYLE (25-2017)

Parts A - Flares & Rubber Strip



Parts B - Parts for Installation



Parts C - Parts for Bolt & Nut Style only (optional)



Caution: Always check the package & parts, ensure the fitment of flare and follow the instruction carefully. PSI will not be responsible for painting & orther cost incurred to incorrect fender flares, failure of installation, shipping damage and or any modified flares.

1. Pre-Installation



1. Prefit and ensure both left (driver) side & right (passenger) side fender flare to the vehicle before painting or installation.
2. You may remove any moldings, strips or existing flares from the vehicle for fitting and installation.

3. Clean Vehicle Body & Fender Flare

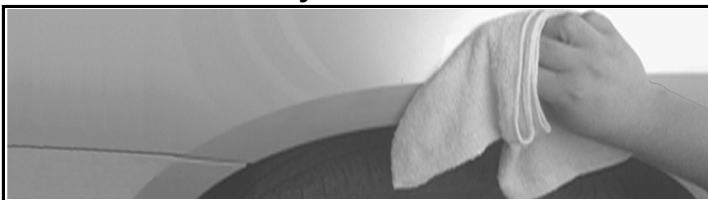

1. Wash and wipe dry the areas of contact on the vehicle body.
2. Clean the surface and inside edge of the fender flare where the rubber seal is to be attached.

2. Paint Flare(Optional)

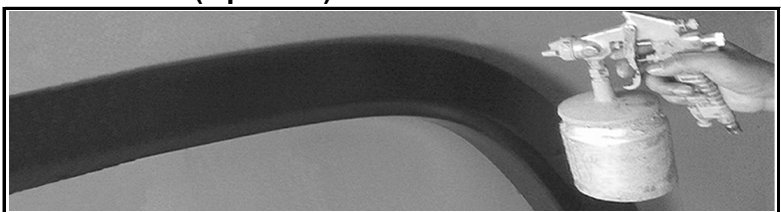

1. Hire a professional painter or body shop and follow the paint manufacturer specifications to paint the flares.
2. Clean all fender flare surface with clean water & a mild detergent before paint, don't use lacquer thinner or any solvent based product

4. Apply Rubber Seal

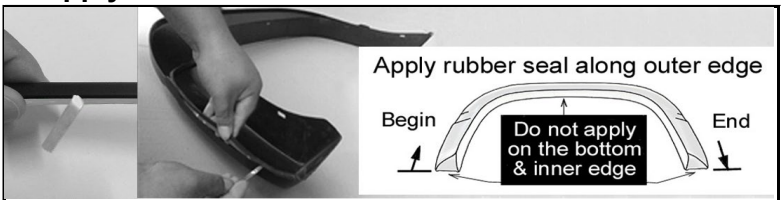

1. Remove 1 inch tape liner from rubber seal, apply it on the flare, start one end & along the edge that comes in contact with body panel. **Caution: 3M tape will be sticked on the inside of the flare.**
2. Make sure the rubber seal along the edge well, rip the tape liner off gradually, apply pressure on the tape in the same time to ensure that it be adhesied well. Trim excess rubber seal and so on.

5. Install Allen Bolt & Nut (PRO-OFFROAD Style)

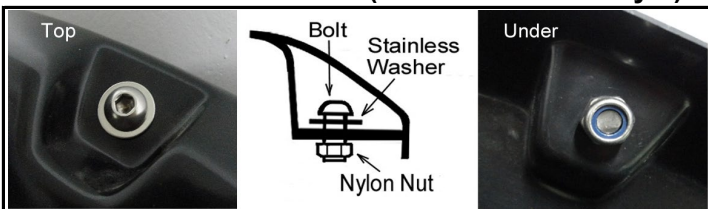

1. Use torx bit to tight allen bolt & nylon nut firmly on every pocket of the fender flares. **DO NOT OVER TIGHTEN !**
2. For Pocket with Bolt Style, skip 6,7,8, go step 9 directly.
3. For Pocket with Light Style, ignore step 5, go step 6 and on.

6. Installation (Left Front Flare Shown)

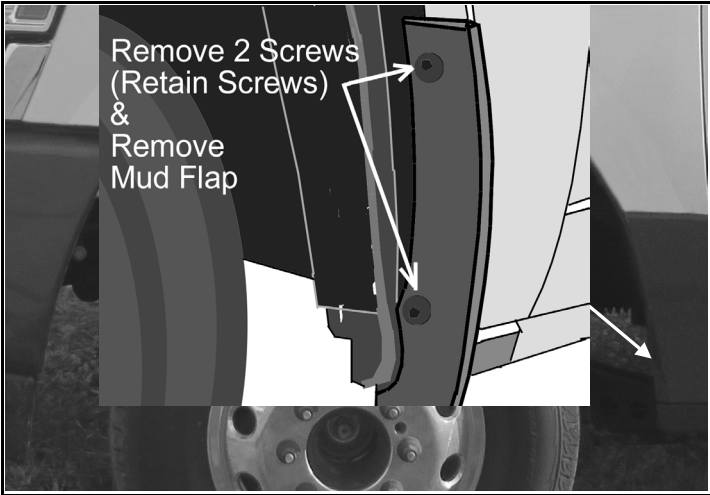

1. Remove and retain 2 screws from the mud flap.
2. Move the mud flap away from the vehicle.

7. Installation (Left Front Flare Shown)



1. Remove and retain 4 screws from the vehicle.

8. Installation (Left Front Flare Shown)

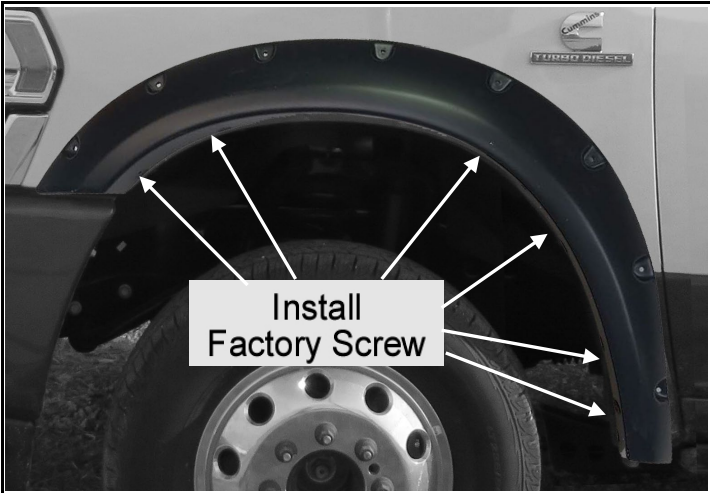

1. Re-Install 6 existing factory screws into the original location that were previously removed (step 9 & 10).
Do not tighten the screws fully until the flare are aligned and extrusive against the body.

9. Installation (Left Rear Flare Shown)

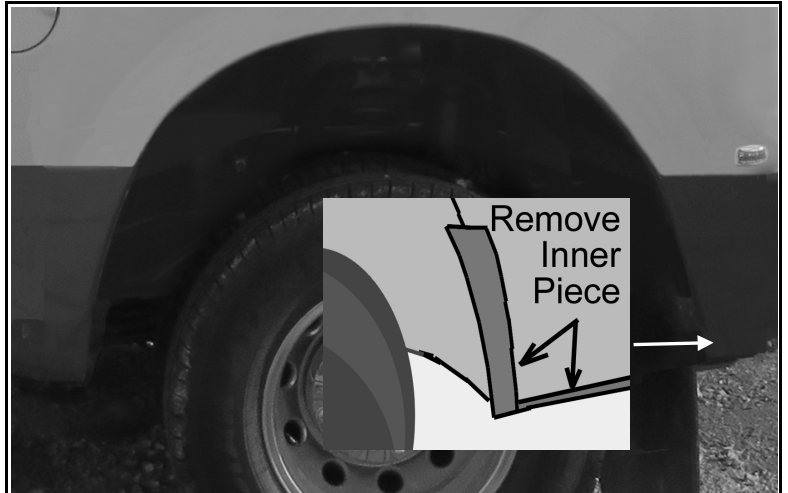

1. If you encounter a fit problem **for different models**, using a pry tool to remove the inner pieces at the bottom rear of wheel well.

10. Installation (Left Rear Flare Shown)



11. Installation (Left Rear Flare Shown)

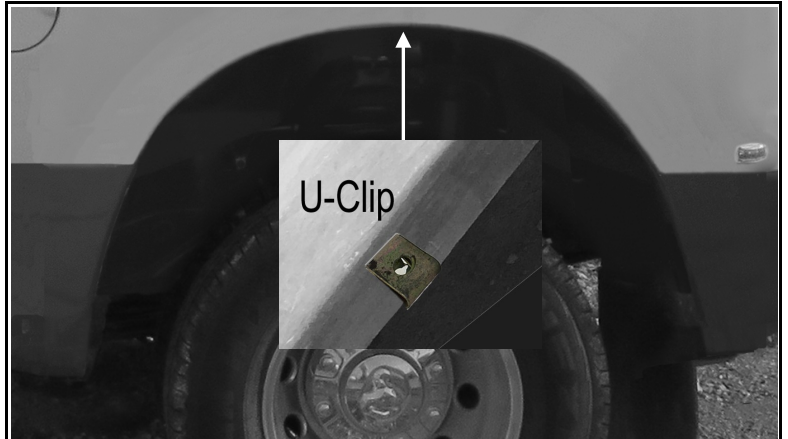

1. Remove and retain 6 screws from the vehicle.
2. **Do not remove** 2 screws on the top, indicated with mark X.

12. Installation (Left Rear Flare Shown)

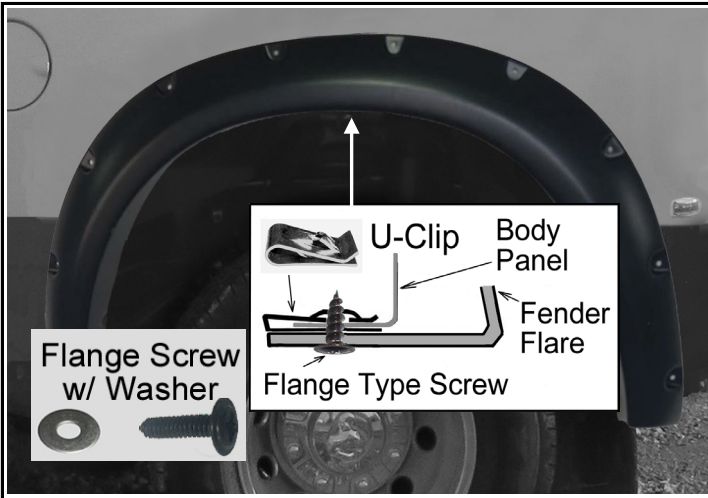

1. Secure 1 flange screw with washer into the U-clip .

14. Installation (Left Rear Flare Shown)

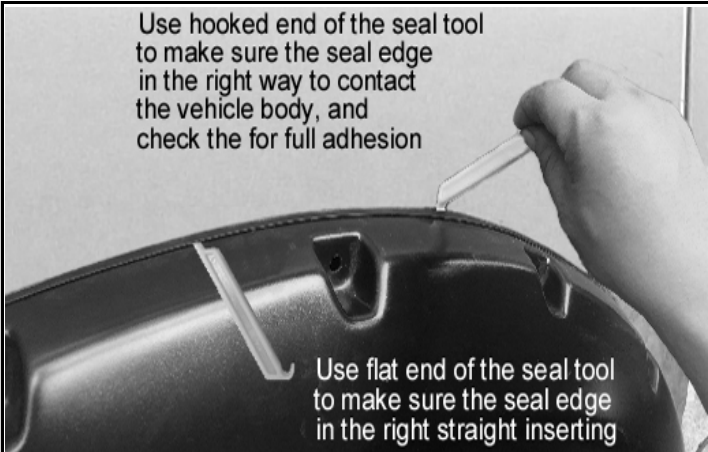

1. You may skip this step if you have right seal installation on step 4. and right flare applying on each.
2. Use hooked end of the seal tool to make sure the seal edge in the right way to contact the vehicle body, sliding it along full edge. Use the the flat end of the seal tool to make sure the seal edge in the right strait inserting, do it along full edge.

Optional : The included self tapping screw may be used for extra secure if it need to be.

1. Apply a U-clip, using a pointed tool to align with top center factory hole.

13. Installation (Left Rear Flare Shown)

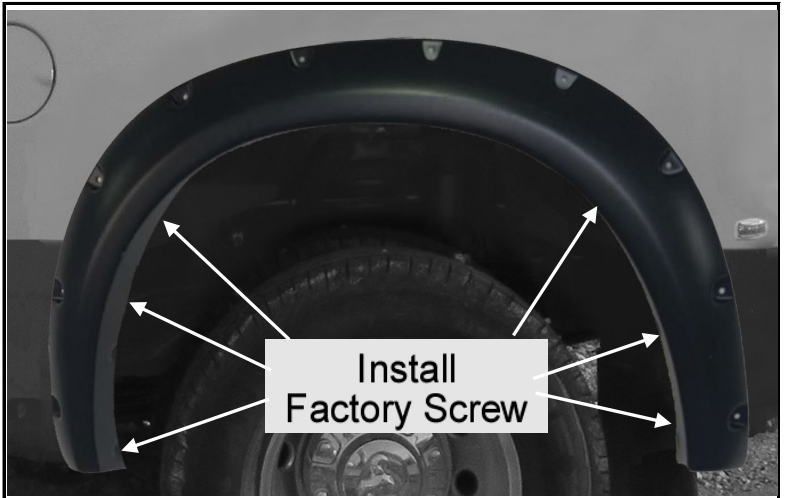

1. Re-Install 6 existing factory screws into the original location that were previously removed (step 13).
Do not tighten the screws fully until the flare are aligned and extrusive against the body.

