



RDJ Trucks PRO-OFFROAD Bolt-On Style Fender Flares
RDJ Trucks PRO-X-TEND Style Fender Flares

Installation Instructions - Ford F150 - 2018-2020

***NOT Compatible with 68T Technology Package**

Part# **10-3012S / 10-3012T** (PRO-OFFROAD Smooth / Textured Finish)

Part# **25-3012S / 25-3012T** (PRO-X-TEND Smooth / Textured Finish)

*****ATTENTION***ATTENTION***ATTENTION*****
YOU MUST READ THE FOLLOWING POINTS BEFORE PROCEEDING WITH ANY STEP OF INSTALLATION

1. Inspect your fender flares for shipping damage immediately upon receipt. Shipping damage must be reported within 48 hours of receipt.
2. Test fit all flare pieces to your vehicle before beginning any other step to confirm you have received the correct set of fender flares for your application. Ensure that all pieces in the parts list below are present.
3. While professional installation is always recommended, RDJ Trucks fender flares can be installed by handy individuals with the proper tools. However, it is a 2-man job. Attempting to achieve a proper fit on one's own is highly discouraged.
3. Due to the tolerances allowed by the motor companies during the assembly of the vehicles, some adjustments or modifications may be necessary to achieve a proper fit.
4. PAINTING - All inspections and test fittings must be made prior to painting the fender flares. No claim of damage, fitment or other defects/errors may be made after painting has occurred. RDJ Trucks is not liable for any costs incurred from painting and/or associated labor.
5. Most importantly, we know that when it comes to choosing fender flares for your truck, you have a multitude of options. We are extremely grateful that you put your faith in our small company. If you experience any issues or if there is anything we can do to assist you, please don't hesitate to contact us - info@rdjtrucks.com

PARTS LIST



80#-0319LF
LEFT FRONT
& INNER PC



80#-0319RF
RIGHT FRONT
& INNER PC



80#-0319LR
LEFT REAR



80#-0319RR
RIGHT REAR



R0300
(324")



U-CLIP &
FLANGE
TYPE-A SCREW
6 PCS EA



LONG CLIP &
TRUSS SCREW
10 PCS EA



S-CLIP & TRUSS
MACHINE
SCREW
2 PCS EA



PLASTIC
FASTENER
2 PCS



SELF
TAPPING
SCREW
8PCS



ALLEN BOLT
34 PCS



NYLON NUT
34 PCS



WASHER
34 PCS



TORX BIT
1 PC

*****POCKET HARDWARE NOT INCLUDED WITH***
 PRO-X-TEND SERIES FLARES**

1. RUBBER WEATHER SEAL APPLICATION

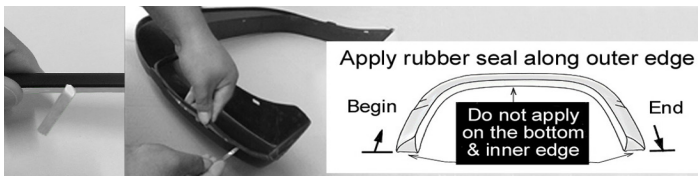

1. Thoroughly clean inside top edge of each flare (where the 3M adhesive will touch) with an alcohol based cleaner.
2. Do not peel the red backing off of the 3M adhesive until instructed. Beginning with the first flare, apply the rubber weather seal in roughly 1 foot sections at a time. From the starting end, leave an extra 1 inch of trim off of the end of the flare so that you can grab and peel the red adhesive backing.
3. With roughly 1 foot of trim applied to the edge, peel the red adhesive backing, pulling it out a few inches at a time. At the same time, press trim firmly in place, ensuring that it is securely adhered to the edge of the flare.
4. Continue the same process in 1 foot sections until the trim is firmly adhered to the entire outer edge of the flare. With a razor knife, cut off the excess trim from each end of the flare.
5. Repeat process for remaining flares.

3. FRONT FLARE - INSTALLATION (DRIVER)

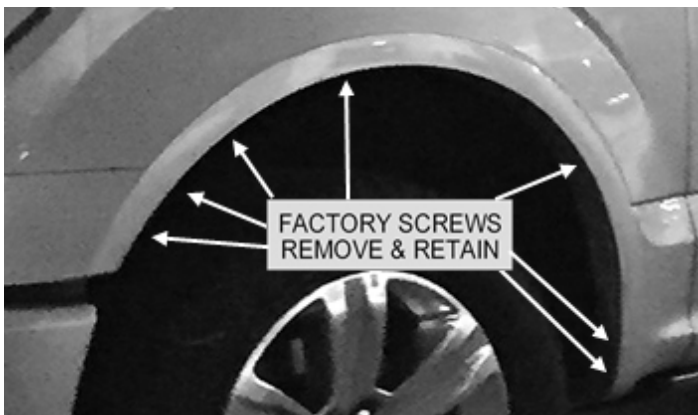

1. Remove the 7 existing factory screws and save for re-installation as shown. **OEM flares must be removed before continuing with installation.

5. FRONT FLARE - INSTALLATION (DRIVER) - CONT.

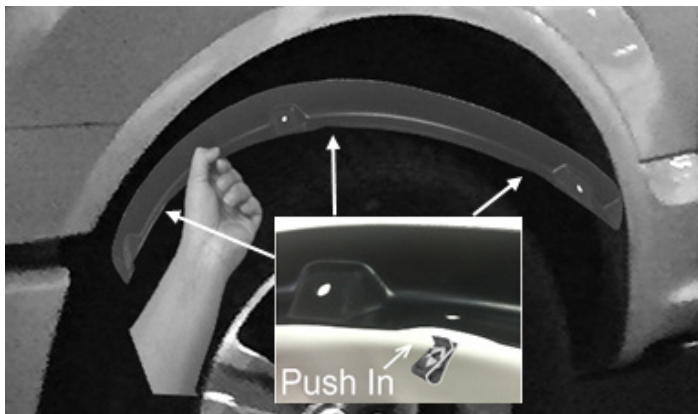

1. Install 3 U-Clips over the holes on the inner bracket as shown.

2. POCKET BOLT APPLICATION

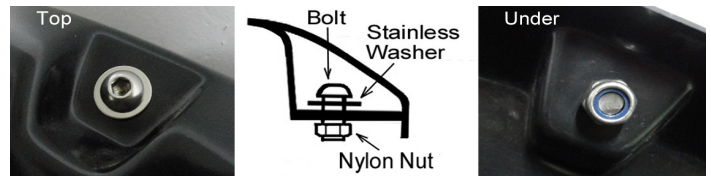

*SKIP THIS STEP FOR PRO-X-TEND SERIES FLARES

1. Apply washer to allen bolt and insert allen bolt into each pocket hole.
*NOTE: Washer should be on the outside of the flare underneath the allen bolt head, NOT on the backside under the nylon nut.
2. Apply nylon nut to allen bolt and tighten carefully. Do not overtighten.
3. Repeat for each pocket.

4. FRONT FLARE - INSTALLATION (DRIVER) - CONT.

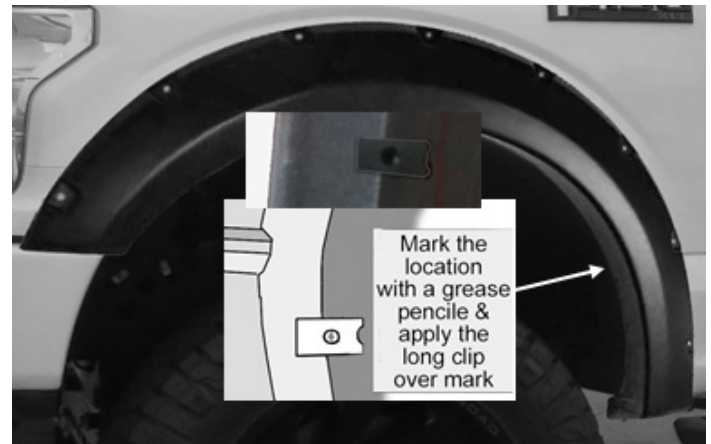

1. With a helper, hold the flare firmly in position and use a grease pencil to mark through 6 hole locations in the flare to the fender well.
2. Remove the flare and insert one long clip over the lip at the single marked location shown above.

6. FRONT FLARE - INSTALLATION (DRIVER) - CONT.

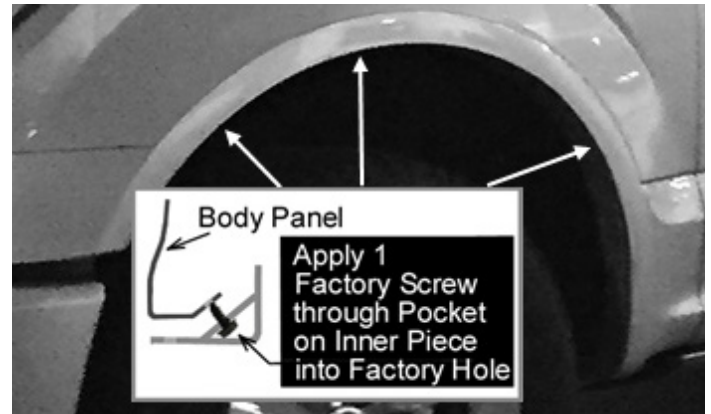

1. Be sure you have the correct inner bracket for the driver side and familiarize yourself with the proper location to mount. Line up the mounting holes in the inner bracket with the 3 uppermost factory holes.
2. Re-install 3 factory screws through the inner bracket into the factory holes in the fender well.

7. FRONT FLARE - INSTALLATION (DRIVER) - CONT.

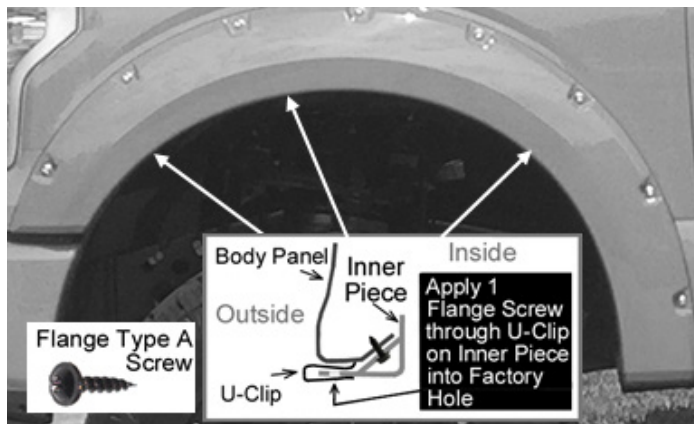

1. With a helper, firmly hold the flare in place on the fender, aligning the 3 uppermost mounting holes with the U-Clips on the inner bracket.
2. Insert 3 flange screws through the flare and into the U-Clips on the inner bracket.

8. FRONT FLARE - INSTALLATION (DRIVER) - CONT.

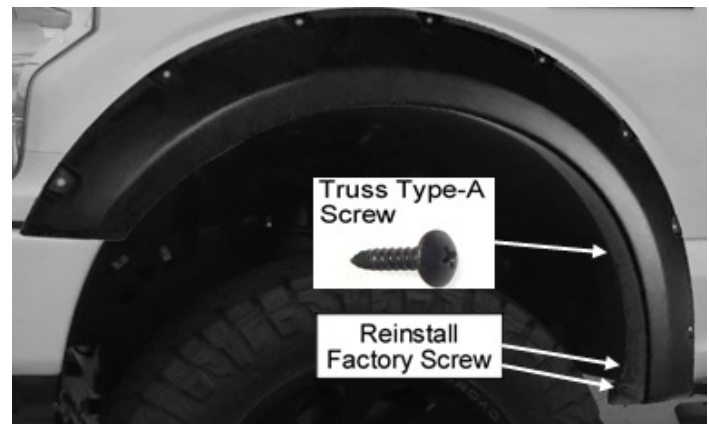

1. Continue holding the flare firmly in place and confirm that the long clip is aligned with the hole in the flare. Adjust long clip if necessary.
2. Apply 1 truss screw through the flare and into the long clip. Re-install the two factory screws removed in step 3.

9. REAR FLARE - INSTALLATION (DRIVER)

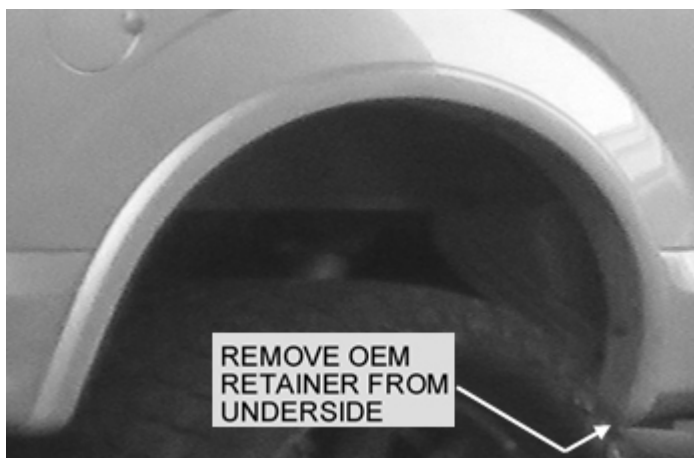

1. Remove the factory retainer from the bottom rear of the wheel well and discard.

10. REAR FLARE - INSTALLATION (DRIVER) - CONT.

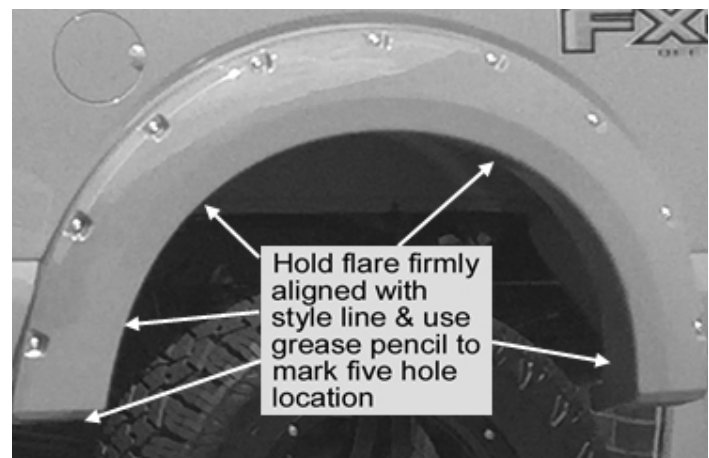

1. With a helper, firmly place the flare on the fender in the proper position and use a grease pencil mark the 5 hole locations in the fender well.

11. REAR FLARE - INSTALLATION (DRIVER) - CONT.

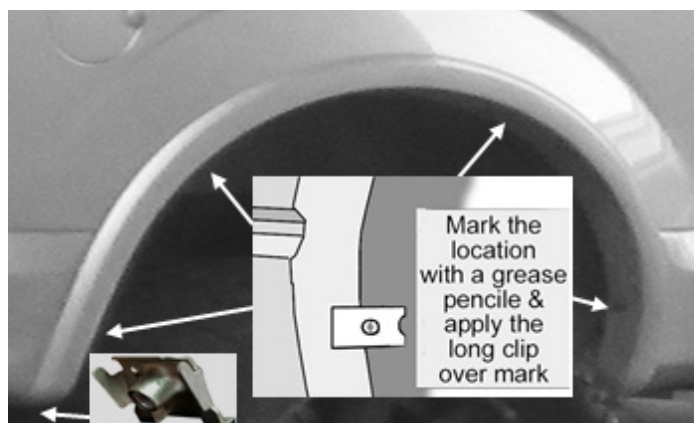

1. Remove the flare and apply four long clips over the marks made in the previous step shown above.
2. Install an S-Clip on the lower front of the wheel well, aligning with the mark made in the previous step.

12. REAR FLARE - INSTALLATION (DRIVER) - CONT.

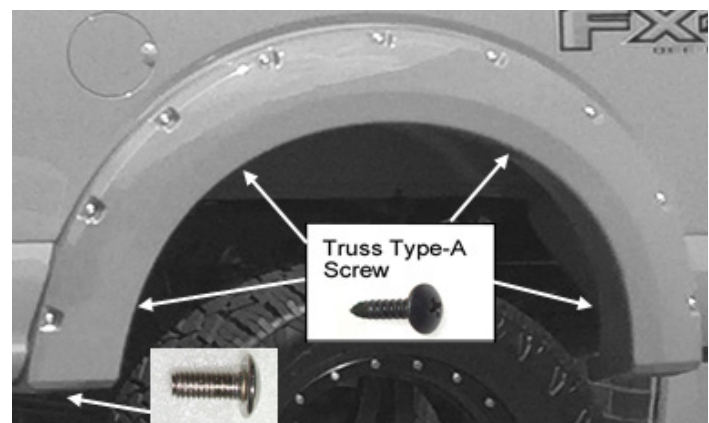

1. Again, mount the flare in the proper position on the fender and secure with 4 Truss Type-A screws through the flare and into the long clips, starting with the 2 uppermost and working outward.
2. Apply one Truss Machine Screw into the S-Clip installed at the lower front of the wheel well in the previous step.

13. REAR FLARE - INSTALLATION (DRIVER) - CONT.

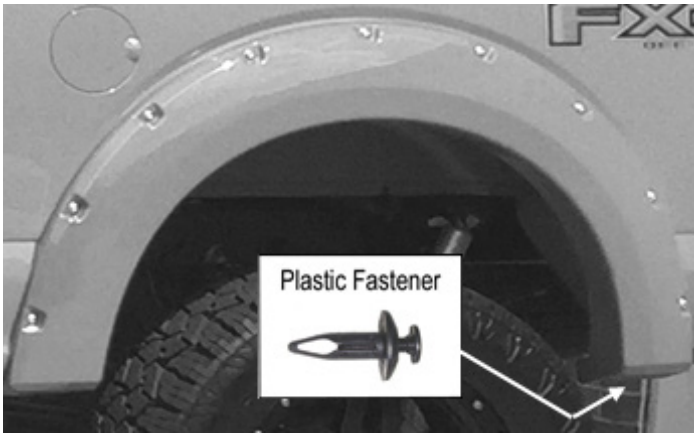

1. Apply one Plastic Fastener through the bottom rear hole of the flare and into the original factory hole.

Repeat steps 3-13 for the passenger side and proceed to step 14 for final inspection.

14. FINAL INSPECTION

1. Due to the tolerances allowed by the motor companies during assembly of the vehicle, adjustments may be necessary to work out any gaps that may occur and ensure a proper, flush fit.

2. Supplied self-tapping screws may be inserted in any location that is in need of additional support. With a helper holding the flare flush against the fender of the truck, insert self-tapping screws through the inner lip of the flare and into fender well wall. Repeat as needed.

3. Check rubber weather seal to ensure a proper seat. Make sure that the top edge of the rubber weather seal is not folded under, behind the flare at any point. If necessary, use the seal tool properly seat the rubber weather seal.

DON'T FORGET
ABOUT OUR TRAVEL-PRO
65-SERIES TONNEAU COVERS

TRI-FOLDING HARD FLIP STYLE
INSTALL AND REMOVE IN LESS THAN 5 MINUTES!



FOLLOW US & WIN!!

**BE SURE TO FOLLOW US & TAG US IN YOUR PICTURES FOR
A CHANCE TO WIN A 100% REBATE OF YOUR PURCHASE!
A NEW WINNER DRAWN EVERY MONTH!!**



@RDJ_TRUCKS



@RDJTRUCKS