



RDJ Trucks PRO-OFFROAD Bolt-On Style Fender Flares
RDJ Trucks PRO-X-TEND Style Fender Flares

Installation Instructions - **GMC Sierra 2500HD 2015-2019**

Part# **10-4025S / 10-4025T** (PRO-OFFROAD Smooth / Textured Finish)

Part# **25-4025S / 25-4025T** (PRO-X-TEND Smooth / Textured Finish)

Part# **30-4025S / 30-4025T** (PRO-POPPED Smooth / Textured Finish)

*****ATTENTION***ATTENTION***ATTENTION*****
YOU MUST READ THE FOLLOWING POINTS BEFORE PROCEEDING WITH ANY STEP OF INSTALLATION

1. Inspect your fender flares for shipping damage immediately upon receipt. Shipping damage must be reported within 48 hours of receipt.
2. Test fit all flare pieces to your vehicle before beginning any other step to confirm you have received the correct set of fender flares for your application. Ensure that all pieces in the parts list below are present.
3. While professional installation is always recommended, RDJ Trucks fender flares can be installed by handy individuals with the proper tools. However, it is a 2-man job. Attempting to achieve a proper fit on one's own is highly discouraged.
3. Due to the tolerances allowed by the motor companies during the assembly of the vehicles, some adjustments or modifications may be necessary to achieve a proper fit.
4. PAINTING - All inspections and test fittings must be made prior to painting the fender flares. No claim of damage, fitment or other defects/errors may be made after painting has occurred. RDJ Trucks is not liable for any costs incurred from painting and/or associated labor.
5. Most importantly, we know that when it comes to choosing fender flares for your truck, you have a multitude of options. We are extremely grateful that you put your faith in our small company. If you experience any issues or if there is anything we can do to assist you, please don't hesitate to contact us - info@rdjtrucks.com

PARTS LIST



802-0123LF
LEFT FRONT
FLARE



802-0123RF
RIGHT FRONT
FLARE



802-0123LR
LEFT REAR
FLARE



802-0123RR
RIGHT REAR
FLARE



R0300
(324")



FLANGE TYPE-A
SCREW
8 PCS



TRUSS TYPE-A
SCREW
14 PCS



WASHER
14 PCS



SELF
TAPPING
SCREW
8PCS



ALLEN BOLT
38 PCS



NYLON NUT
38 PCS



WASHER
38 PCS



TORX BIT
1 PC

*****POCKET HARDWARE NOT INCLUDED WITH***
PRO-X-TEND SERIES FLARES**

1. RUBBER WEATHER SEAL APPLICATION

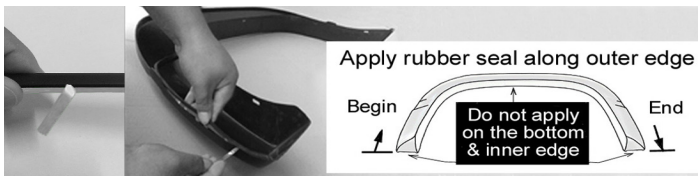

1. Thoroughly clean inside top edge of each flare (where the 3M adhesive will touch) with an alcohol based cleaner.
2. Do not peel the red backing off of the 3M adhesive until instructed. Beginning with the first flare, apply the rubber weather seal in roughly 1 foot sections at a time. From the starting end, leave an extra 1 inch of trim off of the end of the flare so that you can grab and peel the red adhesive backing.
3. With roughly 1 foot of trim applied to the edge, peel the red adhesive backing, pulling it out a few inches at a time. At the same time, press trim firmly in place, ensuring that it is securely adhered to the edge of the flare.
4. Continue the same process in 1 foot sections until the trim is firmly adhered to the entire outer edge of the flare. With a razor knife, cut off the excess trim from each end of the flare.
5. Repeat process for remaining flares.

2. POCKET BOLT APPLICATION

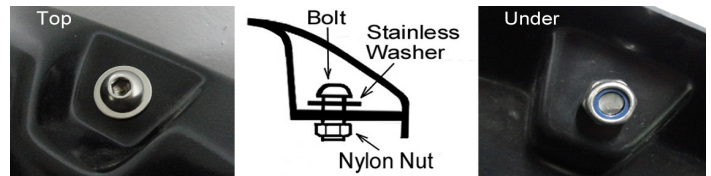

*SKIP THIS STEP FOR PRO-X-TEND SERIES FLARES

1. Apply washer to allen bolt and insert allen bolt into each pocket hole.
*NOTE: Washer should be on the outside of the flare underneath the allen bolt head, NOT on the backside under the nylon nut.
2. Apply nylon nut to allen bolt and tighten carefully. Do not overtighten.
3. Repeat for each pocket.

3. FRONT FLARE - INSTALLATION (DRIVER)



1. Turn the tire outward for easier access to the fender well.
2. For models with factory mudflaps, remove 5 mud flap fasteners with T-30 & T-15 torx bits and screw driver. Save the upper two fasteners for re-installation later.

4. FRONT FLARE - INSTALLATION (DRIVER) - CONT.

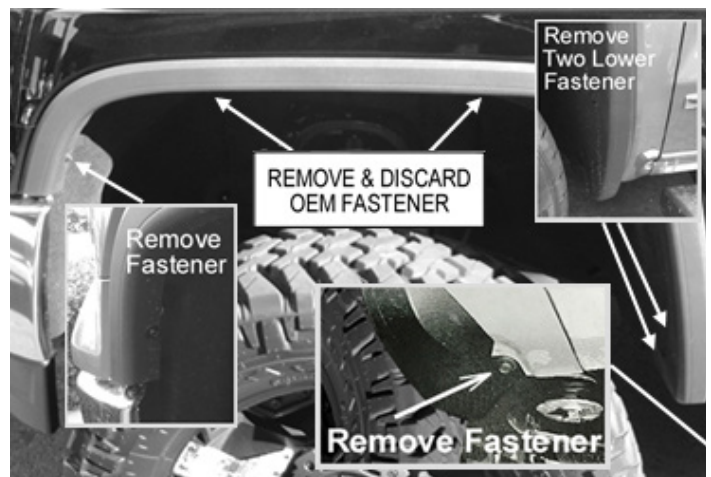

1. Use a 9/32" or 7mm socket to remove the fastener on the front of the factory fender trim and retain for re-installation.
2. Use a T-15 torx bit to remove two lower fasteners on the rear of the factory fender trim.
3. Use a 1/2" socket to remove the fastener from the rear underside of the factory fender trim. Save for re-installation.
4. Use a T-15 torx bit to remove two fasteners along the top middle of the factory fender trim and discard.

5. FRONT FLARE - INSTALLATION (DRIVER) - CONT.

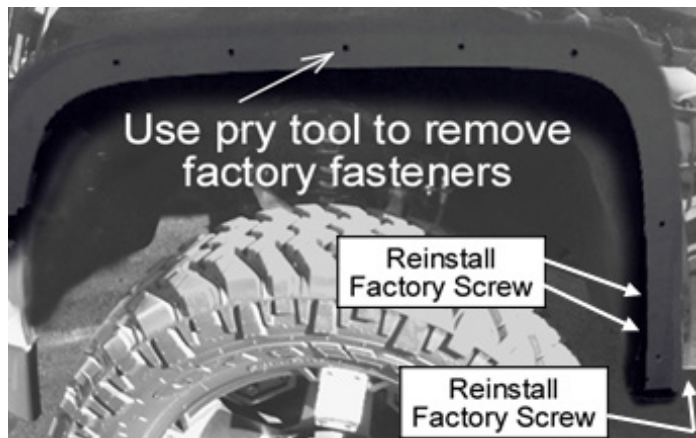

1. Pull the factory fender trim off of the vehicle.
2. Use a pry tool to remove any remaining fasteners
3. For models with factory mud flaps, re-install the upper two fasteners that were removed in step 3-2.
4. Use a 1/2" socket to re-install fastener that was removed in step 4-3 from the underside of the factory fender trim.

6. FRONT FLARE - INSTALLATION (DRIVER) - CONT.



1. With a helper, hold the flare firmly in position on the fender.
2. For models with factory mud flaps, make sure that the other holes in the flare are lined up properly with the existing factory holes and use a grease pencil to mark the hole in the rear of the flare.
3. Remove the flare from the vehicle.
4. Using a 3/32" drill bit, drill a hole through the wheel well lining and the sheet metal on the location marked earlier.

7. FRONT FLARE - INSTALLATION (DRIVER) - CONT.

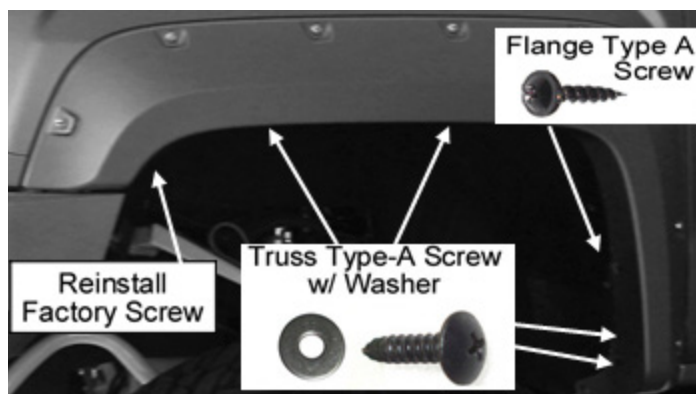

1. Again, with a helper, hold the flare firmly in position on the fender.
2. Install 4 supplied Truss Type-A screws through the flare and into the factory holes as shown.
3. Re-install the factory screw removed in step 4-1.
4. Install 1 supplied Flange Type-A screw through the flare and into the hole drilled in step 6-4.
5. Make sure all fasteners are snug but not overtightened. Slight adjustments may need to be made to achieve a tight, flush fit. Repeat on passenger side.

8. REAR FLARE - INSTALLATION (DRIVER)

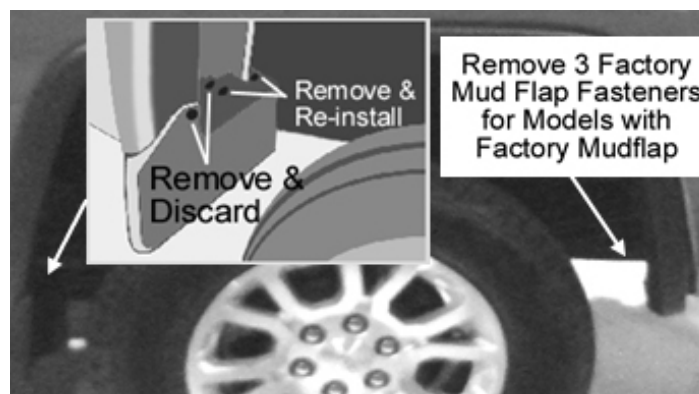

1. Remove 4 factory screws from the forward mud guard and remove from the wheel well.
2. Re-install 2 factory screws into the wheel well liner as shown.
3. For models with factory mud flaps, remove 3 mud flap fasteners with a screw driver.

9. REAR FLARE - INSTALLATION (DRIVER) - CONT.

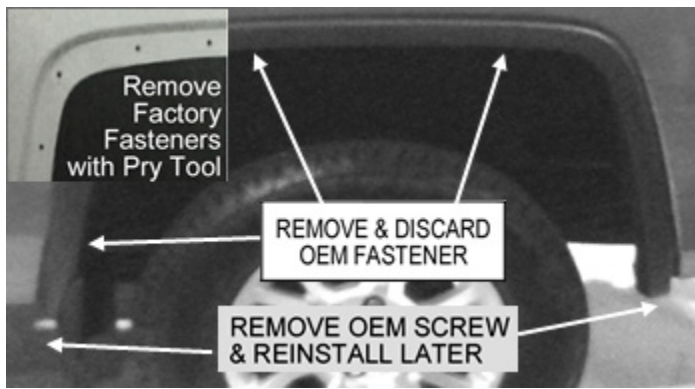

1. Use a 10mm socket to remove 2 lower screws and save for later.
2. Use a T-15 torx bit to remove the other 3 fasteners.
3. Remove the factory fender trim from the vehicle.
4. Use a pry tool to remove any remaining fasteners.

10. REAR FLARE - INSTALLATION (DRIVER) - CONT.



1. With a helper, hold the flare firmly in place on the fender to familiarize yourself with the proper position.
2. Making sure that the remaining holes in the flare are aligned with the existing holes, use a grease pencil to mark the 3 holes as shown.
3. Remove the flare.

11. REAR FLARE - INSTALLATION (DRIVER) - CONT.

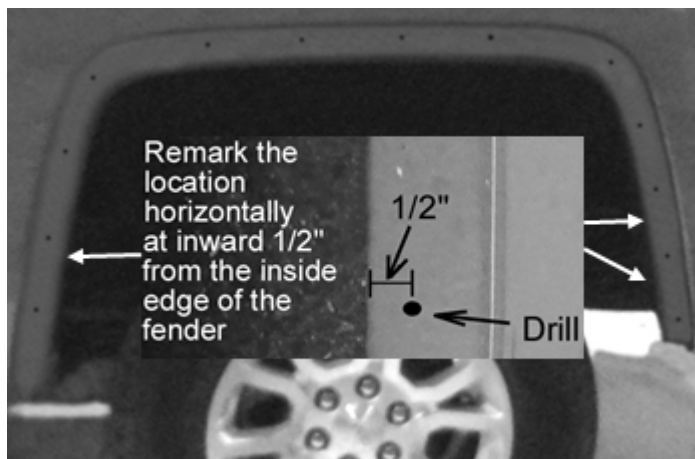

1. Using the marks from step 10-2, measure horizontally inward 1/2" and make new marks.
2. Using a 3/32" drill bit, drill a hole on the new marked locations, through the sheet metal.
3. If needed, use a floor jack, placed under the hitch to raise the rear of the truck for better access to the wheel well.

12. REAR FLARE - INSTALLATION (DRIVER) - CONT.

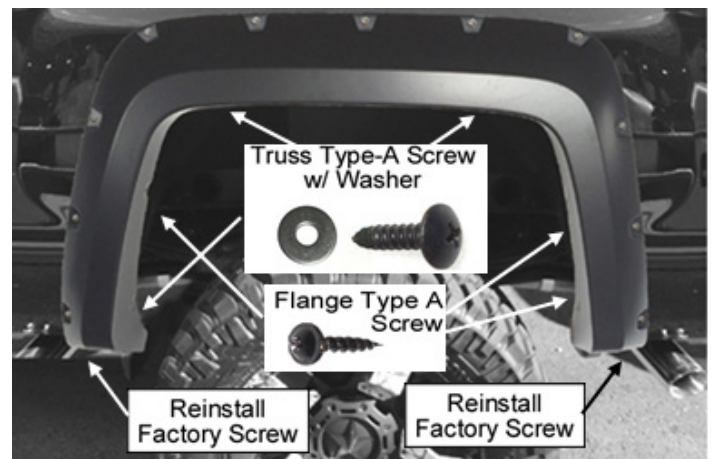

1. With a helper, place the flare firmly on the fender in the proper location.
2. Install 3 supplied Truss Type-A screws through the flare and into the factory holes as shown.
3. Re-install 2 factory screws (removed in step 9-1) on the underside of the flare.
4. Install 3 supplied Flange Type-A screws into the holes drilled in step 11-2.
5. Make sure all fasteners are snug but not overtightened. Slight adjustments may need to be made to achieve a tight, flush fit. Repeat on passenger side.

13. FINAL INSPECTION

1. Due to the tolerances allowed by the motor companies during assembly of the vehicle, adjustments may be necessary to work out any gaps that may occur and ensure a proper, flush fit.
2. Supplied self-tapping screws may be inserted in any location that is in need of additional support. With a helper holding the flare flush against the fender of the truck, insert self-tapping screws through the inner lip of the flare and into fender well wall. Repeat as needed.
3. Check rubber weather seal to ensure a proper seat. Make sure that the top edge of the rubber weather seal is not folded under, behind the flare at any point. If necessary, use the seal tool to properly seat the rubber weather seal.