

FENDER FLARE INSTALLATION INSTRUCTION

Item No 10-5015WL

PRO-OFFROAD Bolt-On Style Fender Flares

RDJ TRUCKS

Make & Model

NISSAN TITAN 2004-2014

(with Storage Door)

Parts A - Flares & Rubber Strip

800-0711LF	800-0711RF	800-0711LR	800-0711RR	R0300	T1193
Left Front Flare	Right Front Flare	Left Rear Flare	Right Rear Flare	Rubber Seal	Seal Tool
1 pc	1 pc	1 pc	1 pc	1 roll(324")	1 pc

Parts B - Parts for Installation

S0508	C1717	P0800/G0805	G0813	S0650	S0432
Machine Screw	S-Clip	Fastener w/spacer	Spacer 13mm	Truss Screw	Self Tapping Screw
15 pcs	15 pcs	2 pcs	1 pcs	1 pcs	8 pcs

Parts C - Parts for Bolt & Nut Style only (optional)

B0817	N0800	W0820	T4500
Allen Bolt	Nylon Nut	Washer	Torx Bit
36 pcs	36 pcs	36 pcs	1 pc

Parts D - Parts for LED Light Style only (optional)

				PATENT PRODUCT
LED Bolt & Nut	Washers	LED Light	Wire	
36 pcs/ea	36 pcs/ea	36 pcs/ea	4 rolls	

(8 pcs LED sets for front flares/10 pcs LED sets for rear flares)

Caution: Always check the package, ensure the fitment of fender flare and follow the instruction carefully. PSI will not be responsible for painting & orther cost incurred to incorrect fender flares, failure of installation, shipping damage or modified flares.

1. Pre-Installation

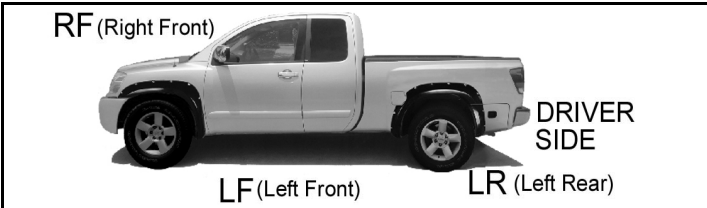

1. Prefit and ensure both left (driver) side & right (passenger) side fender flare to the vehicle before painting or installation.
2. You may remove any moldings, strips or existing flares from the vehicle for fitting and installation.

3. Clean Vehicle Body & Fender Flare

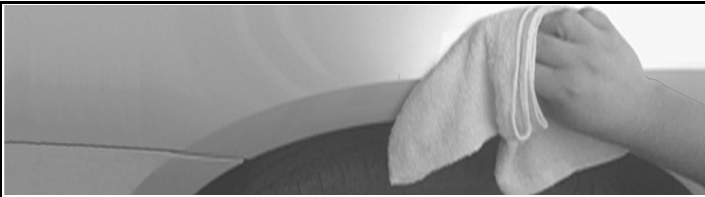

1. Wash and wipe dry the areas of contact on the vehicle body.
2. Clean the surface and inside edge of the fender flare where the rubber seal is to be attached.

5. Install Allen Bolt & Nut (Pocket with Bolt Style)

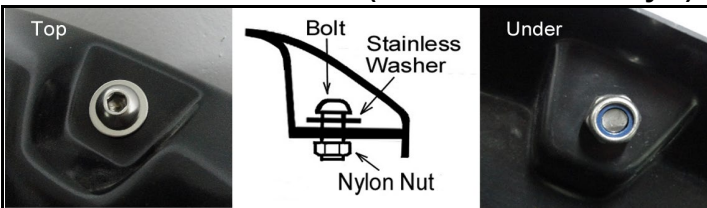

1. Use Torx Bit to tight allen bolt & nylon nut firmly on every pocket of the fender flares. **DO NOT OVER TIGHTEN !**
2. For Pocket-n-Bolt Style, skip 6,7,8, go step 9 directly.
3. For Pocket with Light Style, ignore step 5, go step 6 and on.

2. Paint Flare(Optional)

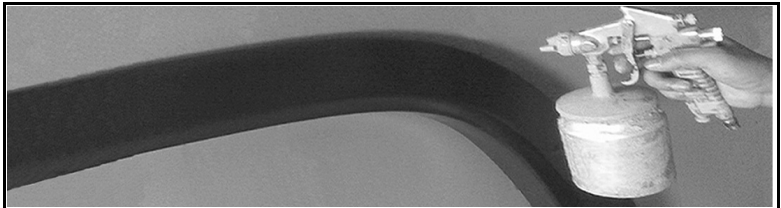

1. Hire a professional painter or body shop and follow the paint manufacturer specifications to paint the flares.
2. Clean all fender flare surface with clean water & a mild detergent before paint, don't use lacquer thinner or any solvent based product

4. Apply Rubber Seal

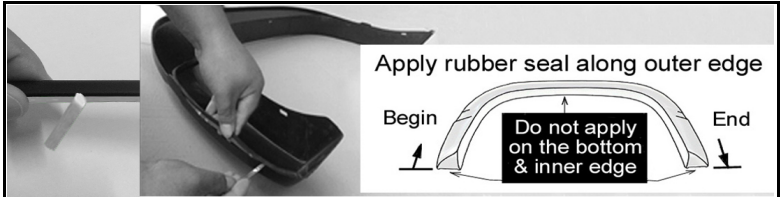

1. Remove 1 inch tape liner from rubber seal, apply it on the flare, start one end & along the edge that comes in contact with body panel. **Caution: 3M tape will be sticked on the inside of the flare.**
2. Make sure the rubber seal along the edge well, rip the tape liner off gradually, apply pressure on the tape in the same time to ensure that it be adhesied well. Trim excess rubber seal and so on.

6. Install LED Light (Pocket with LED Light Style)

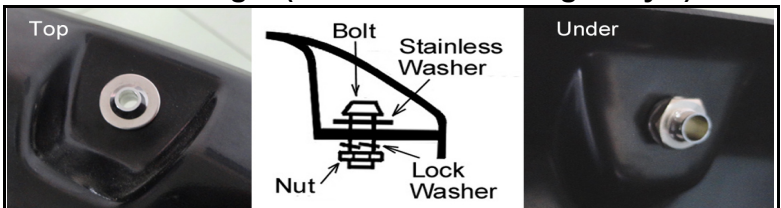

1. Tight LED Bolt, washer & nut with lock washer on every pocket of the flares. **ENSURE THE BOLTS ARE TIGHTEN ENOUGH !**

7. Install LED Light (Pocket with LED Light Style)

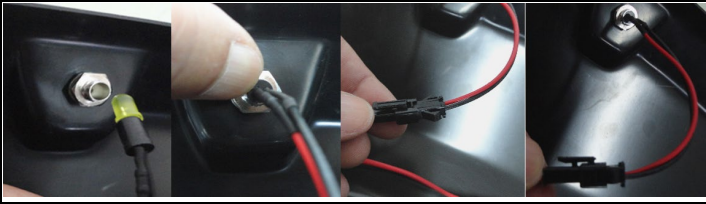

1. Insert the LED to the LED Bolt, push it into the end with nail **(see illustration)**. **DO NOT HOLD THE WIRE TO PUSH IT !**
2. To connect the connector, just push the clip side down on the female part and stoper side on the male part together.
3. To replace the LED if necessary, just push down the LED from **top side** & take it out. **DO NOT PULL OUT WITH WIRE**
4. To unplug the connector, just push down the clip end on the female part, pinch two side wing on the male part and pull straight out the male part.

9. Installation (Left Front Flare Shown)

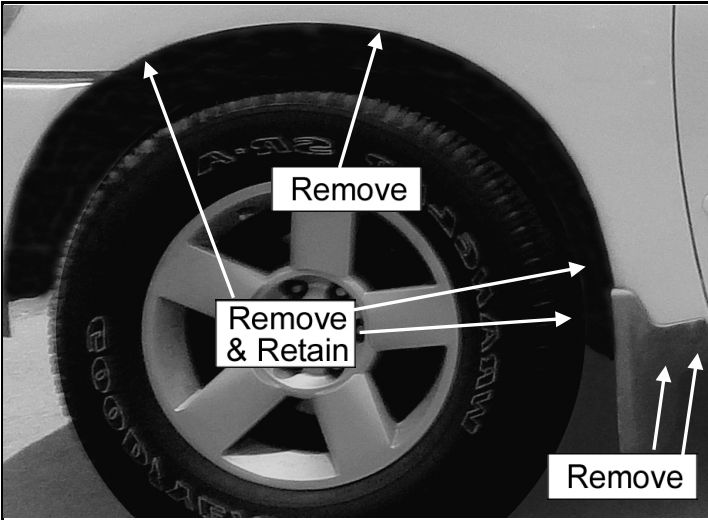

1. **With Mud Flap-** Remove existing screws & 1 extra screw above, save screws for reinstallation. **(see illustration)**
2. **Without Mud Flap-** Remove 2 factory screws on the side,
3. Remove 1 factory screw located at most front of fender, just above the bumper, save screw for reinstallation.
4. Remove 1 factory screw located at most top of fender.

11. Installation (Right Rear Flare Shown)

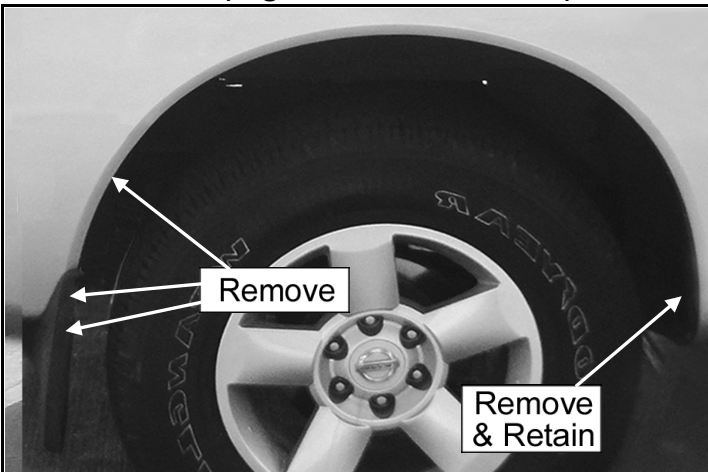

1. **With Mud Flap-** Remove existing screws & 1 extra screw above. **(see illustration)**
2. Remove 1 factory screw located at most front of fender, save screw for reinstallation. **(see illustration)**

8. Install LED Light (Pocket with LED Light Style)

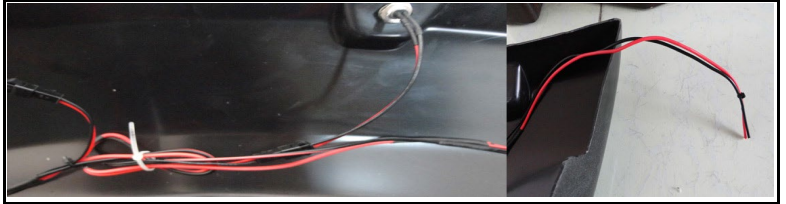

1. Tight the losing wire on the proper place.
2. The LED wire end should be toward to the front in the front flare, to the rear in the rear flare.
3. Use the extension wire **(NOT INCLUDED)** to connect LED wire and the parking light, turn signal light or other electric source as your desire. If in doubt on the connection, get professional advice before connect it.
4. You may add a switch in between LED set and electric source to control it on and off easily.

10. Installation (Left Front Flare Shown)

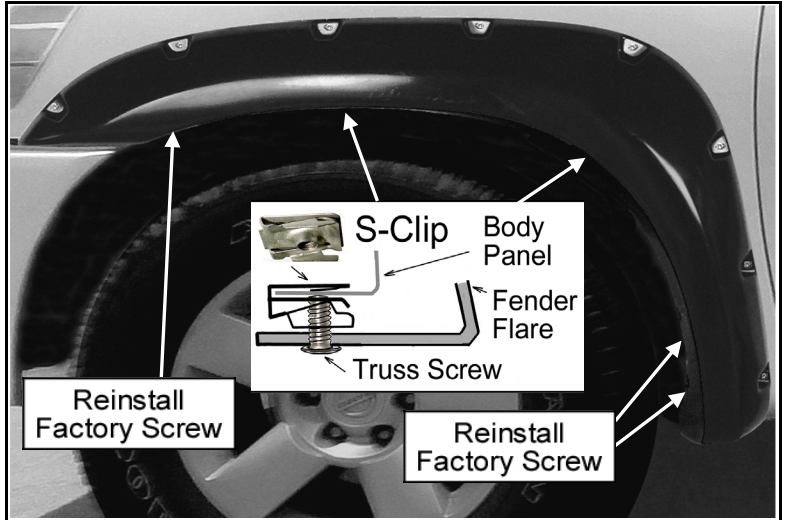

1. Apply 2 S-Clip over 2 location and secure it with 2 machine screws. (Do not fully tighten screws) **(see right illustration)**
2. Line up the 3 holes in flare with factory holes and hold the flare firmly, reinstall 3 factory screws into the holes that were previously removed. **(see right illustration)**
3. Tighten the screws on S-Clip.

12. Installation (Right Rear Flare Shown)

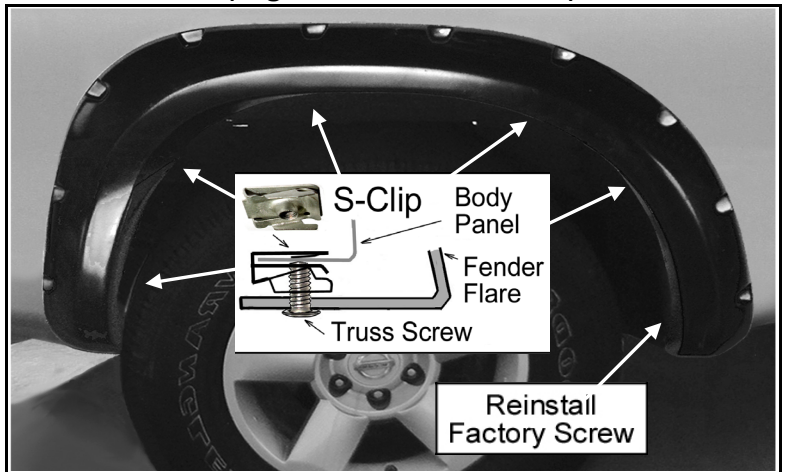

1. Apply 5 S-Clip over 5 location and secure it with 5 machine screws. (Do not fully tighten screws) **(see right illustration)**
2. Line up the hole in flare with factory hole and hold the flare firmly, reinstall factory screw into the hole that were previously removed. **(see right illustration)**
3. Tighten the screws on S-Clip.

13. Installation (Left Rear Flare Shown)

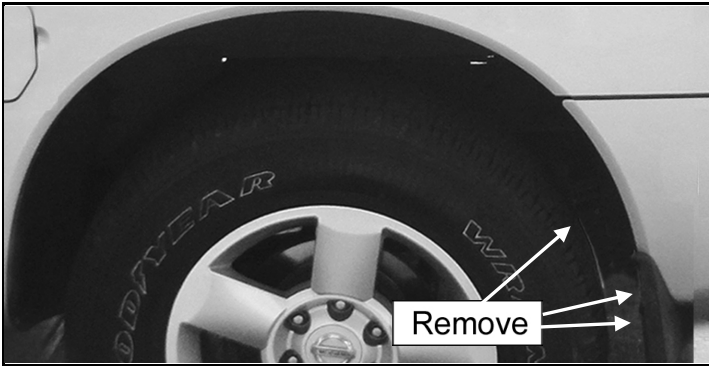

Left Side with Mud Flap Shown

1. Remove existing screws & 1 extra screw above.
(see illustration)

14. Installation (Left Rear Flare Shown)

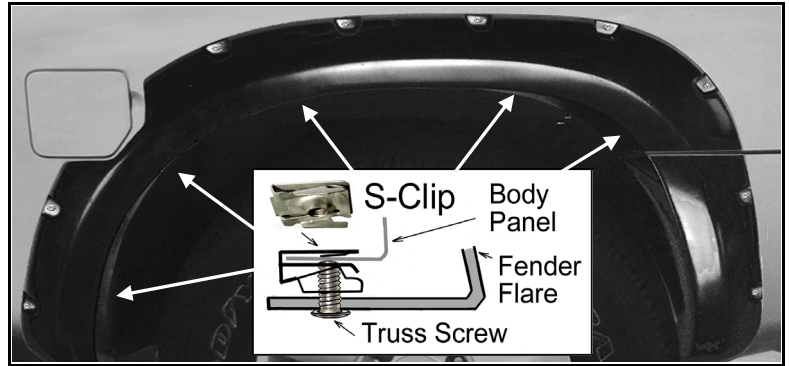

Left Side Shown

1. Apply 5 S-Clip over 5 location and secure it with 5 machine screws, as **illustration**. (Do not fully tighten screws)
2. Line up the flare properly and hold the flare firmly, tighten all screws, start from right side toward the access door.

15. Installation (Left Rear Flare Shown)

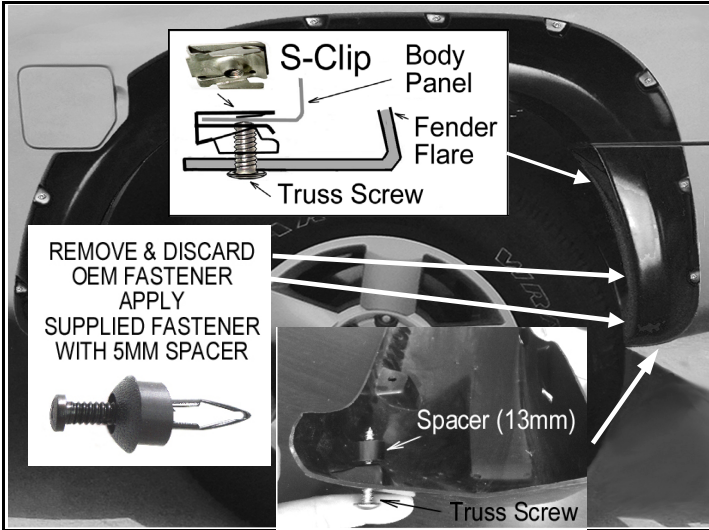

Left Side without Mud Flap Shown

1. Pry out the factory fastener on the bottom of the door & discard
2. Open the access door and remove the edge protector from the door lip and discard.
3. Install supplied truss screw through spacer(13mm) into factory hole on the bottom of the fender, **as lower right shown**. (Do not fully tighten screw)
4. Apply 1 S-Clip over the location and secure it with machine screw, **as top shown**. (Do not fully tighten screw)
5. Apply 2 supplied fastener with 5mm spacer (on outside of flare) into factory holes, **as center shown**.
6. Line up the flare properly and hold the flare firmly, tighten all screws.

16. Installation (Left Rear Flare Shown)

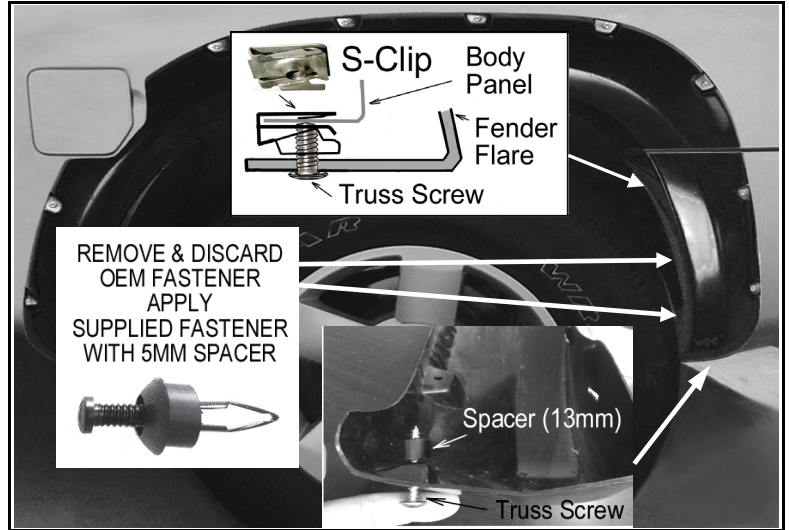

Left Side with Mud Flap Shown

1. Remove factory mud flap and save the hardware.
2. Pry out the factory fastener on the bottom of the door & discard.
3. Open the access door and remove the edge protector from the door lip and discard.
4. Install supplied truss screw through spacer(13mm) into factory hole on the bottom of the fender, **as lower right shown**. (Do not fully tighten screw)
5. Apply 1 S-Clip over the location and secure it with machine screw, **as top shown**. (Do not fully tighten screw)
6. Apply 2 supplied fastener with 5mm spacer (on outside of flare) into factory holes, **as center shown**.
7. Line up the flare properly and hold the flare firmly, tighten all screws

17. Installation (All Flare Shown)

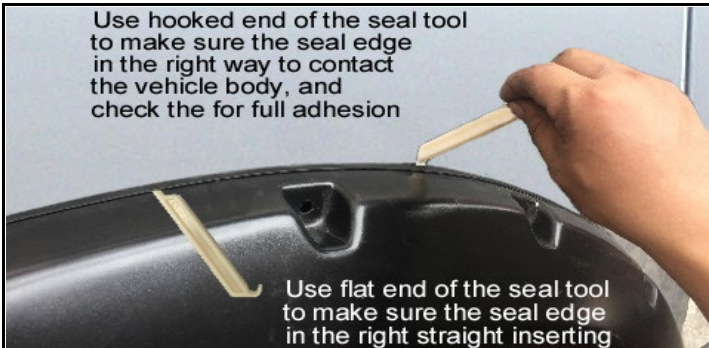

1. You may skip this step if you have right seal installation on step 4. and right flare applying on each.
2. Use hooked end of the seal tool to make sure the seal edge in the right way to contact the vehicle body, sliding it along full edge. Use the the flat end of the seal tool to make sure the seal edge in the right strait inserting, do it along full edge.

Optional : You can use the included self tapping screws to secure the flare if need be.