



RDJ Trucks PRO-OFFROAD Bolt-On Style Fender Flares RDJ Trucks PRO-X-TEND Style Fender Flares

Installation Instructions - Nissan Titan XD 2016-2021

Part# **10-5020** PRO-OFFROAD Bolt-On Style

Part# **25-5020** PRO-X-TEND Streamline Style

ATTENTIONATTENTION***ATTENTION*** YOU MUST READ THE FOLLOWING POINTS BEFORE PROCEEDING WITH ANY STEP OF INSTALLATION

1. Inspect your fender flares for shipping damage immediately upon receipt. Shipping damage must be reported within 48 hours of receipt.
2. Test fit all flare pieces to your vehicle before beginning any other step to confirm you have received the correct set of fender flares for your application. Ensure that all pieces in the parts list below are present.
3. While professional installation is always recommended, RDJ Trucks fender flares can be installed by handy individuals with the proper tools. However, it is a 2-man job. Attempting to achieve a proper fit on one's own is highly discouraged.
3. Due to the tolerances allowed by the motor companies during the assembly of the vehicles, some adjustments or modifications may be necessary to achieve a proper fit.
4. PAINTING - All inspections and test fittings must be made prior to painting the fender flares. No claim of damage, fitment or other defects/errors may be made after painting has occurred. RDJ Trucks is not liable for any costs incurred from painting and/or associated labor.
5. Most importantly, we know that when it comes to choosing fender flares for your truck, you have a multitude of options. We are extremely grateful that you put your faith in our small company. If you experience any issues or if there is anything we can do to assist you, please don't hesitate to contact us - info@rdjtrucks.com

PARTS LIST



802-0713LF
LEFT FRONT
& INNER PC



802-0713RF
RIGHT FRONT
& INNER PC



802-0713LR
LEFT REAR



802-0713RR
RIGHT REAR



R0300
(318")



U-CLIP &
FLANGE
SCREW
2 PCS EA



LONG CLIP
& TRUSS
SCREW
6 PCS EA



PLASTIC
FASTENER
2 PCS



TRUSS
SCREW
14 PCS



WASHER
14 PCS



SELF
TAPPING
SCREW
8 PCS



ALLEN BOLT
33 PCS



NYLON NUT
33 PCS



WASHER
33 PCS



TORX BIT
1 PC

*Pocket hardware not included with PRO-X-TEND style flares

1. RUBBER WEATHER SEAL APPLICATION

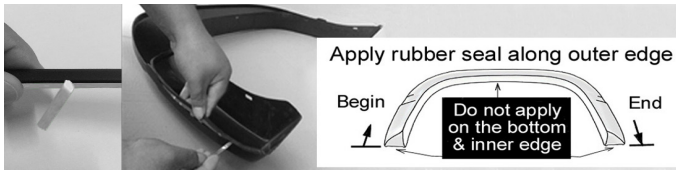

1. Thoroughly clean inside top edge of each flare (where the 3M adhesive will touch) with an alcohol based cleaner.
2. Do not peel the red backing off of the 3M adhesive until instructed. Beginning with the first flare, apply the rubber weather seal in roughly 1 foot sections at a time. From the starting end, leave an extra 1 inch of trim off of the end of the flare so that you can grab and peel the red adhesive backing.
3. With roughly 1 foot of trim applied to the edge, peel the red adhesive backing, pulling it out a few inches at a time. At the same time, press trim firmly in place, ensuring that it is securely adhered to the edge of the flare.
4. Continue the same process in 1 foot sections until the trim is firmly adhered to the entire outer edge of the flare. With a razor knife, cut off the excess trim from each end of the flare.
5. Repeat process for remaining flares.

2. POCKET BOLT APPLICATION

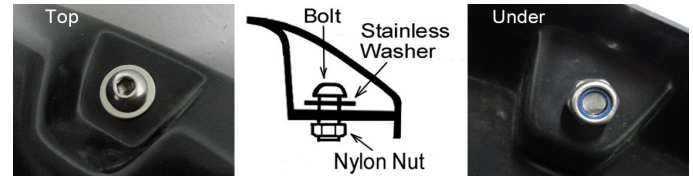

***SKIP THIS STEP FOR PRO-X-TEND SERIES FLARES**

1. Apply washer to allen bolt and insert allen bolt into each pocket hole. ***NOTE:** Washer should be on the outside of the flare underneath the allen bolt head, NOT on the backside under the nylon nut.
2. Apply nylon nut to allen bolt and tighten carefully. Do not overtighten.
3. Repeat for each pocket.

3. FRONT FLARE - OE FLARE REMOVAL (DRIVER)

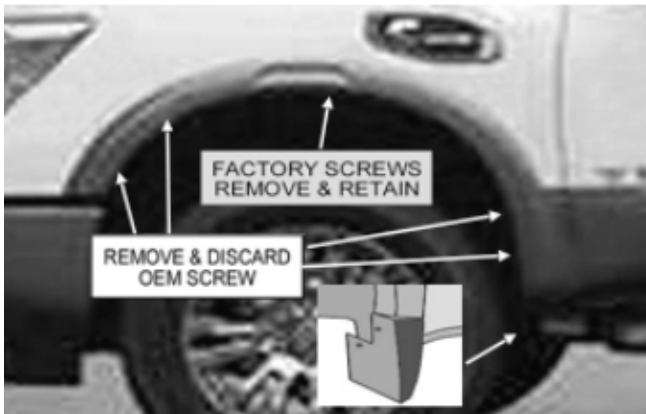

1. If your truck does not have OE fender flares or mud flaps, skip ahead to step 4.
2. Remove five existing factory screws, save one screw on top center for re-installation.
3. Remove the flare as shown. Remove factory mud flaps if installed.

4. FRONT FLARE - INNER BRACKET INSTALLATION

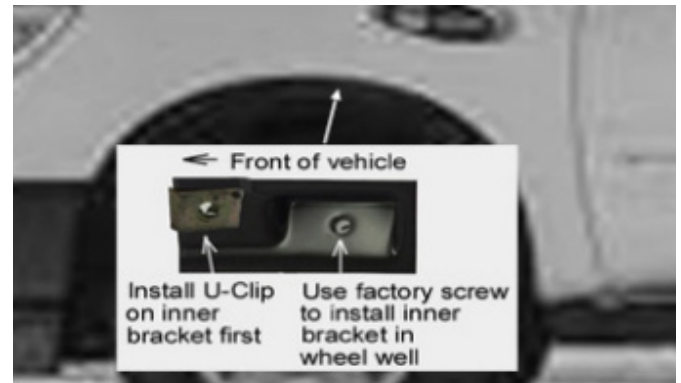

1. Familiarize yourself with the proper location and way to install the inner bracket.
2. Install a U-clip over the hole on the inner bracket.
3. Install a factory screw through the bracket and into the uppermost hole on the fender wheel well.

5. FRONT FLARE - FLARE INSTALLATION

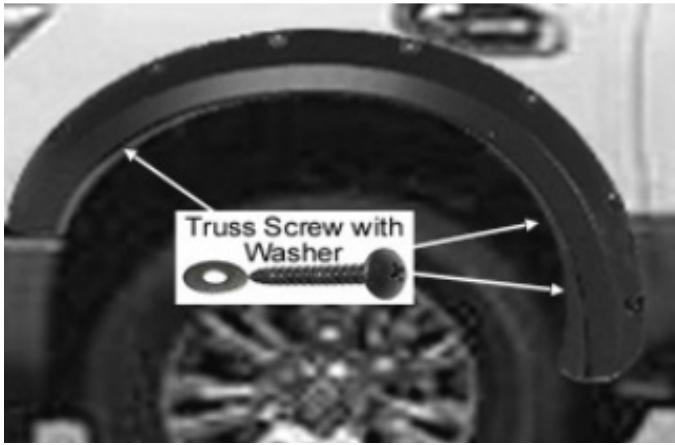

1. Apply three truss Type-A screws through the flare into the factory holes.

6. FRONT FLARE - FLARE INSTALLATION

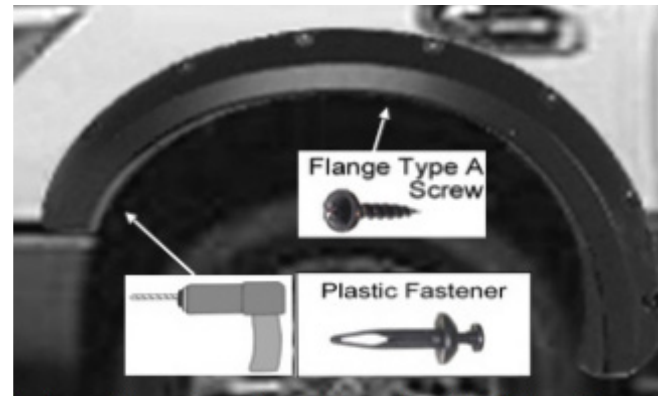

1. Apply one flange screw through the inner bracket, into U-clip and secure it to the vehicle through the uppermost hole, as shown.
2. Firmly push the flare against the fender of the truck to ensure that it is properly positioned flush. Drill a 1/4" hole through the flare into the wheel well and secure the flare to the wheel well lining with a plastic fastener. Repeat on passenger side.

7. REAR FLARE - OE FLARE REMOVAL (DRIVER)

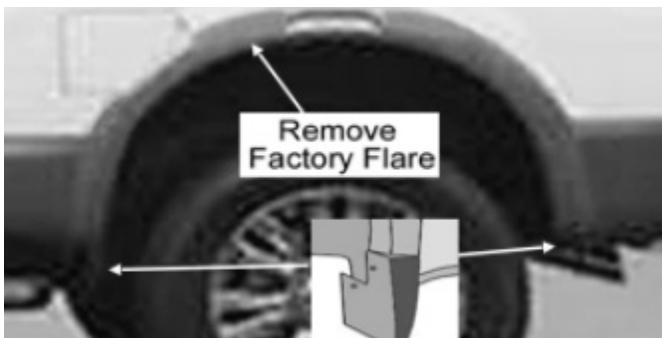

1. If your truck does not have OE fender flares, skip ahead to step 9.
2. Remove all existing factory screws and remove the OE flare.
3. Remove OE mud flap if equipped.

8. REAR FLARE - OE HARDWARE REMOVAL



1. Remove three factory clips on the top center.

9. REAR FLARE - INSTALLATION (DRIVER)



1. Install three long clips over the original factory clip locations.

10. REAR FLARE - INSTALLATION (CONT.)

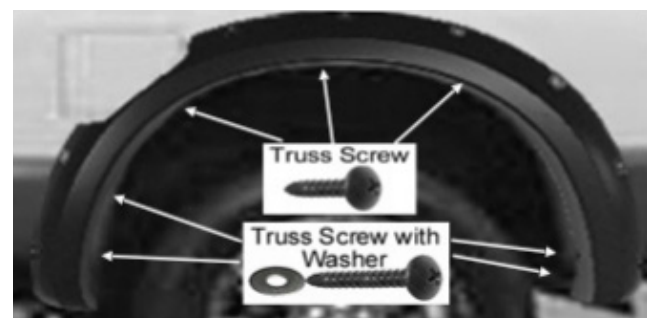

1. Firmly holding the flare in place, secure with 3 truss type screw into the long clips placed in the previous step.
2. Apply 4 truss type-A screws and washers into the factory holes as shown. Tighten all screws, repeat on passenger side.

11. FINAL INSPECTION

1. Due to the tolerances allowed by the motor companies during assembly of the vehicle, adjustments may be necessary to work out any gaps that may occur and ensure a proper, flush fit.
2. Supplied self-tapping screws may be inserted in any location that is in need of additional support. With a helper holding the flare flush against the fender of the truck, insert self-tapping screws through the inner lip of the flare and into fender well wall. Repeat as needed.
3. Check rubber weather seal to ensure a proper seat. Make sure that the top edge of the rubber weather seal is not folded under, behind the flare at any point.



FOLLOW US & WIN!!

BE SURE TO FOLLOW US & TAG US IN YOUR
PICTURES FOR A CHANCE TO WIN A 100%
REBATE OF YOUR PURCHASE!
A NEW WINNER DRAWN EVERY MONTH!!



@RDJ_TRUCKS



@RDJTRUCKS

