



RDJ Trucks PRO-OFFROAD Bolt-On Style Fender Flares RDJ Trucks PRO-X-TEND Streamline Style Fender Flares

Installation Instructions - Toyota Tundra 2014-2021

10-6016 (PRO-OFFROAD) / 25-6016 (PRO-X-TEND) / 30-6016 (PRO-POPPED)

ATTENTIONATTENTION***ATTENTION*** YOU MUST READ THE FOLLOWING POINTS BEFORE PROCEEDING WITH ANY STEP OF INSTALLATION

1. Inspect your fender flares for shipping damage immediately upon receipt. Shipping damage must be reported within 48 hours of receipt.
2. Test fit all flare pieces to your vehicle before beginning any other step to confirm you have received the correct set of fender flares for your application. Ensure that all pieces in the parts list below are present.
3. While professional installation is always recommended, RDJ Trucks fender flares can be installed by handy individuals with the proper tools. However, it is a 2-man job. Attempting to achieve a proper fit on one's own is highly discouraged.
3. Due to the tolerances allowed by the motor companies during the assembly of the vehicles, some adjustments or modifications may be necessary to achieve a proper fit.
4. PAINTING - All inspections and test fittings must be made prior to painting the fender flares. No claim of damage, fitment or other defects/errors may be made after painting has occurred. RDJ Trucks is not liable for any costs incurred from painting and/or associated labor.
5. Most importantly, we know that when it comes to choosing fender flares for your truck, you have a multitude of options. We are extremely grateful that you put your faith in our small company. If you experience any issues or if there is anything we can do to assist you, please don't hesitate to contact us - info@rdjtrucks.com

PARTS LIST



802-0905LF
LEFT FRONT
& INNER PC



802-0905RF
RIGHT FRONT
& INNER PC



802-0905LR
LEFT REAR



802-0905RR
RIGHT REAR



R0300
(324")



T1193
SEAL TOOL



U-CLIP
4 PCS



WASHER
HEAD SCREW
30 PCS



PLASTIC
RETAINER
2PCS



SELF
TAPPING
SCREW
10PCS



ALLEN BOLT
33 PCS



NYLON NUT
33 PCS



WASHER
33 PCS



TORX BIT
1 PC

*POCKET HARDWARE FOR PRO-OFFROAD SERIES ONLY

1. RUBBER WEATHER SEAL APPLICATION

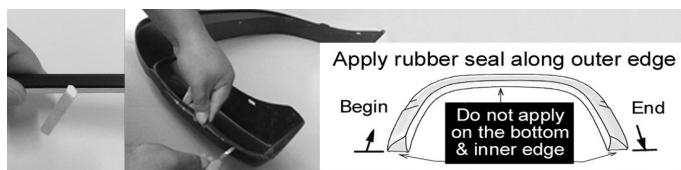

1. Thoroughly clean inside top edge of each flare (where the 3M adhesive will touch) with an alcohol based cleaner.
2. Do not peel the red backing off of the 3M adhesive until instructed. Beginning with the first flare, apply the rubber weather seal in roughly 1 foot sections at a time. From the starting end, leave an extra 1 inch of trim off of the end of the flare so that you can grab and peel the red adhesive backing.
3. With roughly 1 foot of trim applied to the edge, peel the red adhesive backing, pulling it out a few inches at a time. At the same time, press trim firmly in place, ensuring that it is securely adhered to the edge of the flare.
4. Continue the same process in 1 foot sections until the trim is firmly adhered to the entire outer edge of the flare. With a razor knife, cut off the excess trim from each end of the flare.
5. Repeat process for remaining flares.

2. POCKET BOLT APPLICATION

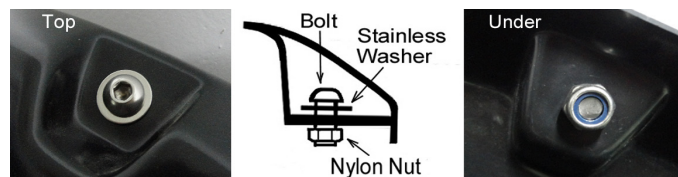

***SKIP THIS STEP FOR X-TEND SERIES FLARES**

1. Apply washer to allen bolt and insert allen bolt into each pocket hole. ***NOTE:** Washer should be on the outside of the flare underneath the allen bolt head, NOT on the backside under the nylon nut.
2. Apply nylon nut to allen bolt and tighten carefully. Do not overtighten.
3. Repeat for each pocket.

3. FRONT FLARE - OE HARDWARE REMOVAL (DRIVER)

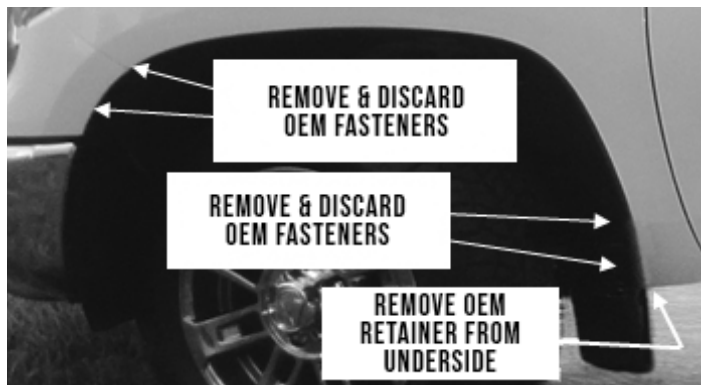

1. Remove 2 existing factory screws from front of the wheel well.
2. Remove 2 existing factory screws from OE mud flap.
3. Remove push-in retainers from under side of mud flap. Remove the OE mud flap from the vehicle.

4. FRONT FLARE - INNER BRACKET INSTALLATION

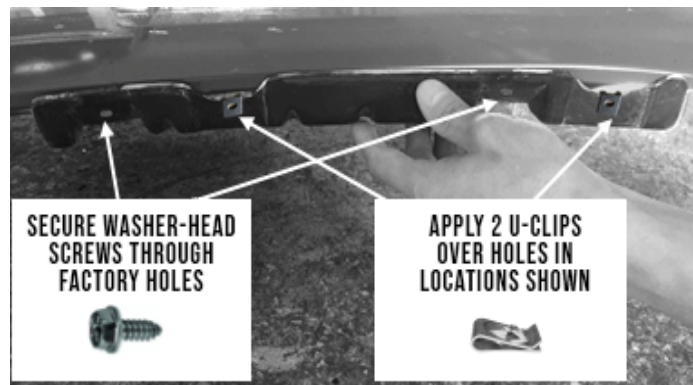

1. Apply 2 U-clips on the bracket as shown.
2. Familiarize yourself with the proper position of the bracket in the top of the wheel well.
3. Fasten 2 washer-head screws through the holes in the bracket and into the factory holes in the top of the wheel well.

5. FRONT FLARE - FLARE INSTALLATION

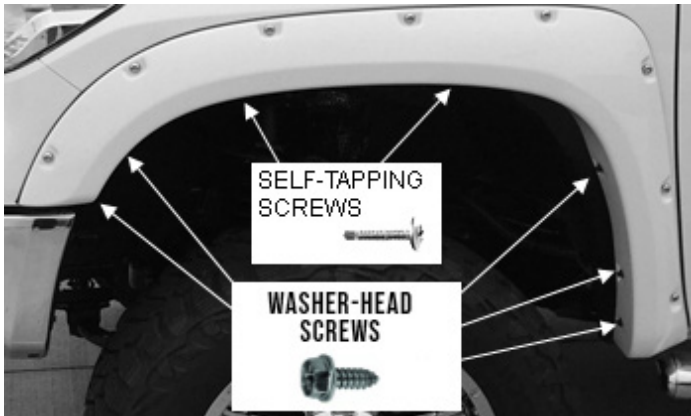

1. With a helper, place the flare firmly in position on the fender. Making sure that the flare is flush with the fender, align the 2 top holes in the flare with the U-clips on the previously mounted inner bracket.
2. Insert 2 supplied self-tapping screws through 2 holes in the top middle of the flare and into the inner bracket.
3. Insert 3 supplied Washer-Head screws through 3 holes in the rear of the flare and into the existing factory holes in the wheel well.
4. Insert 2 supplied Washer-Head screws through 2 holes in the front of the flare and into the existing factory holes. Ensure that the flare is in the proper position and tighten all screws. Repeat all steps on passenger side.

6. REAR FLARE - OE HARDWARE REMOVAL (DRIVER)



1. Remove the existing screw from the factory mud flap.
2. Remove the push-in retainer from the under side of the factory mud flap and remove the mud flap.

7. REAR FLARE - FLARE INSTALLATION



1. With a helper, place the flare firmly in position on the fender.
2. Insert 3 Washer-Head screws through 3 holes in the middle top of the flare, into the factory holes in the wheel well.
3. Insert 2 Washer-Head screws through 2 holes in the rear of the flare, into the factory holes in the wheel well.

8. REAR FLARE - FLARE INSTALLATION (CONT.)

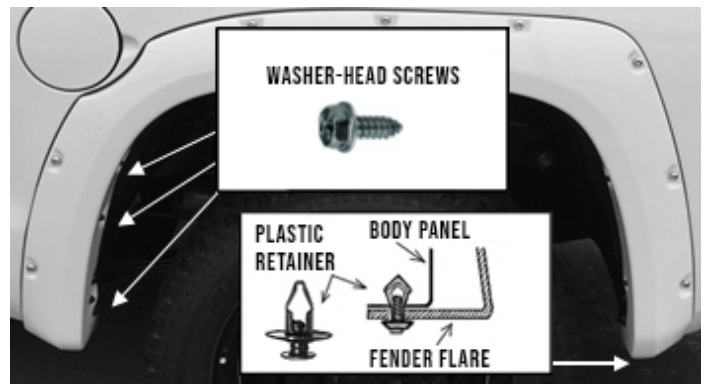

1. Insert 3 Washer-Head screws through 3 holes in the front of the flare, into the factory holes in the wheel well.
2. Insert the plastic retainer into the factory hole on the under side of the flare.
3. Ensure that the flare is properly aligned and flush on the fender. Tighten all screws and repeat on passenger side.

9. FINAL INSPECTION

1. Due to the tolerances allowed by the motor companies during assembly of the vehicle, adjustments may be necessary to work out any gaps that may occur and ensure a proper, flush fit.
2. Supplied self-tapping screws may be inserted in any location that is in need of additional support. With a helper holding the flare flush against the fender of the truck, insert self-tapping screws through the inner lip of the flare and into fender well wall. Repeat as needed.
3. Check rubber weather seal to ensure a proper seat. Make sure that the top edge of the rubber weather seal is not folded under, behind the flare at any point. If necessary, use the seal tool properly seat the rubber weather seal.



FOLLOW US & WIN!!

BE SURE TO FOLLOW US & TAG US IN YOUR
PICTURES FOR A CHANCE TO WIN A 100%
REBATE OF YOUR PURCHASE!
A NEW WINNER DRAWN EVERY MONTH!!



@RDJ_TRUCKS



@RDJTRUCKS



ALSO AVAILABLE

TRAVELPRO 65-SERIES
HARD FLIP TRI-FOLD TONNEAU COVER