



PRO-OFFROAD Bolt-On Style Fender Flares PRO-X-TEND Streamline Style Fender Flares

Installation Instructions - Toyota 4Runner 2014-2021

EXCLUDES Limited Models

Part# 10-6030 (PRO-OFFROAD) / 25-6030 (PRO-X-TEND)

ATTENTIONATTENTION***ATTENTION***

YOU MUST READ THE FOLLOWING POINTS BEFORE PROCEEDING WITH ANY STEP OF INSTALLATION

1. Inspect your fender flares for shipping damage immediately upon receipt. Shipping damage must be reported within 48 hours of receipt.
2. Test fit all flare pieces to your vehicle before beginning any other step to confirm you have received the correct set of fender flares for your application. Ensure that all pieces in the parts list below are present.
3. While professional installation is always recommended, RDJ Trucks fender flares can be installed by handy individuals with the proper tools. However, it is a 2-man job. Attempting to achieve a proper fit on one's own is highly discouraged.
3. Due to the tolerances allowed by the motor companies during the assembly of the vehicles, some adjustments or modifications may be necessary to achieve a proper fit.
4. PAINTING - All inspections and test fittings must be made prior to painting the fender flares. No claim of damage, fitment or other defects/errors may be made after painting has occurred. RDJ Trucks is not liable for any costs incurred from painting and/or associated labor.
5. Most importantly, we know that when it comes to choosing fender flares for your truck, you have a multitude of options. We are extremely grateful that you put your faith in our small company. If you experience any issues or if there is anything we can do to assist you, please don't hesitate to contact us - info@rdjtrucks.com

PARTS LIST



802-0924LF
803-0924LF
LEFT FRONT

802-0924RF
803-0924RF
RIGHT FRONT

802-0924LR
803-0924LR
LEFT REAR

802-0924RR
803-0924RR
RIGHT REAR

R0300
(375")



TORX BOLT
(LONG)
& NUT
2 PCS EA

WASHER
2 PCS

TRUSS
TYPE-A
SCREW
4 PCS

PLASTIC
RETAINER
12 PCS

SELF-
TAPPING
SCREW
8 PCS

3M ADHESIVE
PROMOTOR
PADS
2 PCS

FOR PRO-OFFROAD VERSION ONLY



TORX BOLT
(SHORT)
31 PCS

NYLON NUT
31 PCS

WASHER
31 PCS

TORX BIT
1 PC



Watch the installation & review video by



<https://youtu.be/QEH4mQE9UIk>



1. RUBBER WEATHER SEAL APPLICATION

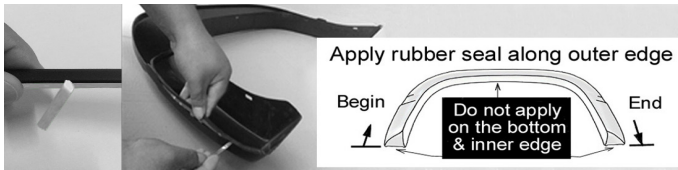

1. Thoroughly clean inside top edge of each flare (where the 3M adhesive will touch) with an alcohol based cleaner.
2. Do not peel the red backing off of the 3M adhesive until instructed. Beginning with the first flare, apply the rubber weather seal in roughly 1 foot sections at a time. From the starting end, leave an extra 1 inch of trim off of the end of the flare so that you can grab and peel the red adhesive backing.
3. With roughly 1 foot of trim applied to the edge, peel the red adhesive backing, pulling it out a few inches at a time. At the same time, press trim firmly in place, ensuring that it is securely adhered to the edge of the flare.
4. Continue the same process in 1 foot sections until the trim is firmly adhered to the entire outer edge of the flare. With a razor knife, cut off the excess trim from each end of the flare.
5. Repeat process for remaining flares.

2. POCKET BOLT APPLICATION

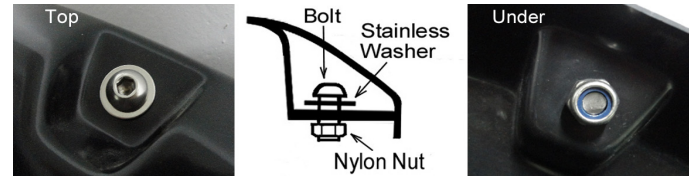

APPLIES TO PRO-OFFROAD STYLE ONLY

FOR PRO-X-TEND STYLE, MOVE ON TO STEP 3

1. Apply washer to allen bolt and insert allen bolt into each pocket hole. *NOTE: Washer should be on the outside of the flare underneath the allen bolt head, NOT on the backside under the nylon nut.
2. Apply nylon nut to allen bolt and tighten carefully. Do not overtighten.
3. Repeat for each pocket.

3. FRONT FLARE INSTALLATION - DRIVER SIDE

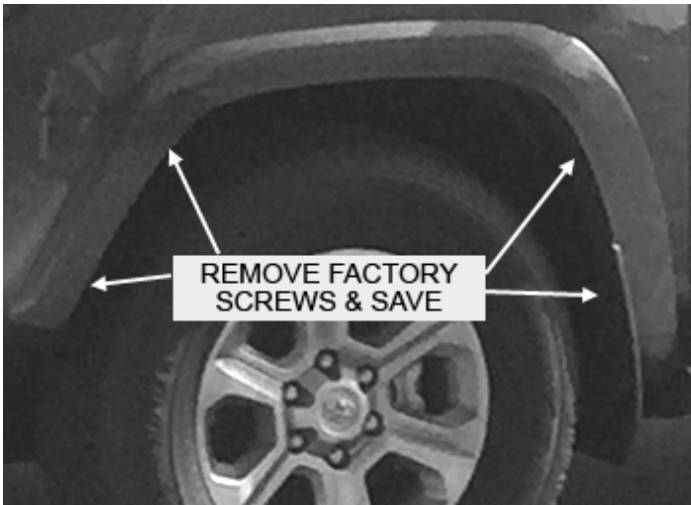

1. Remove 4 factory screws from the locations shown.
2. Save for re-installation.
3. Do NOT remove the factory mud flap (if equipped).

4. FRONT FLARE INSTALLATION - CONTINUED



1. With a helper, place the driver side front flare on the fender firmly in the proper position.
2. Re-install the factory screws removed in the previous step into the same locations.

5. FRONT FLARE INSTALLATION - CONTINUED

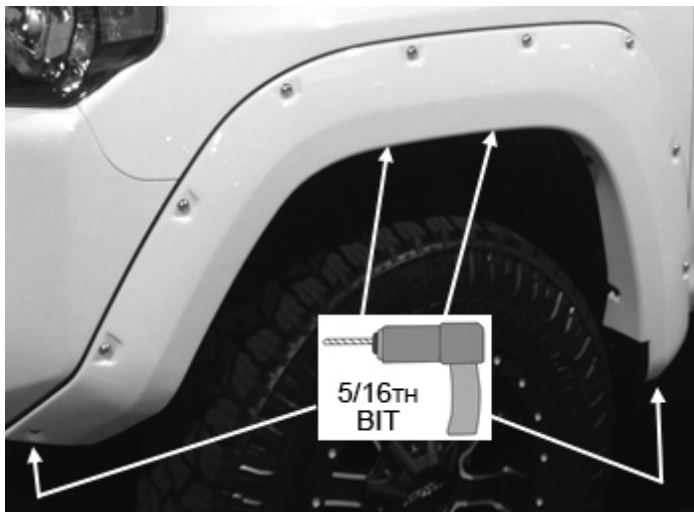

1. With a helper holding the flare firmly in position and flush against the fender, use a 5/16in drill bit to drill through the flare mounting holes in the locations as shown.
2. Make sure to firmly press the flare in place when drilling the two bottom holes.

6. FRONT FLARE INSTALLATION - CONTINUED

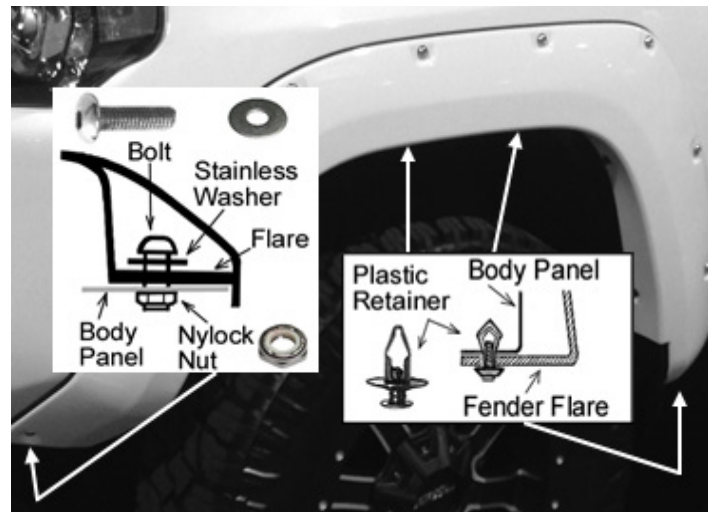

1. Insert one long torx bolt with washer through the bottom forward hole in the flare, as shown (left), securing with a nut from the back side of the bumper cover.
2. Insert 3 plastic retainers through the holes in the flare and into the wheel well as shown (right)
3. Ensure that the flare is positioned properly and tighten all screws. Repeat steps 3-6 on the passenger side.

7. REAR FLARE INSTALLATION - DRIVER

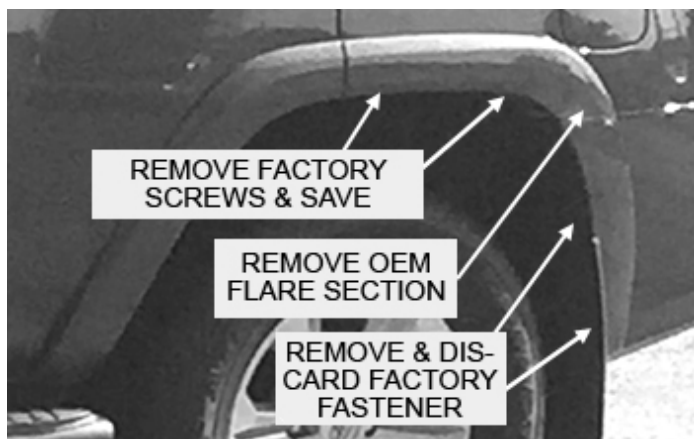

1. Remove 2 factory screws from the main flare at top of the wheel well and save for later.
2. Remove and discard 2 factory fasteners from the lower rear of the wheel well.
3. Remove the main flare from the fender.

8. REAR FLARE INSTALLATION - CONTINUED

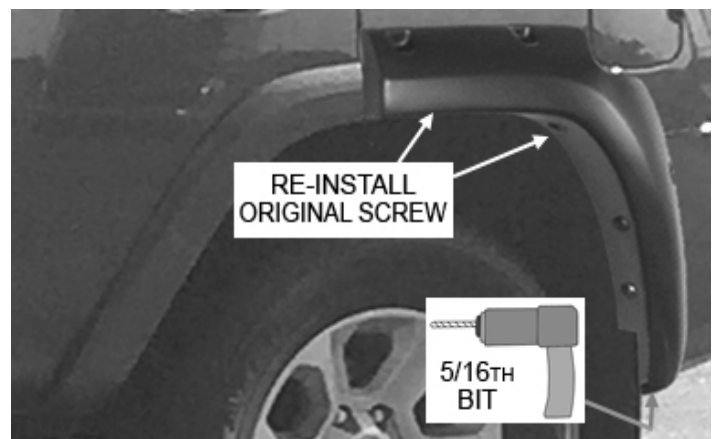

1. With a helper, firmly place the driver side main rear flare on the fender, aligning it with the original factory holes and re-install the two factory screws removed in the previous step.
2. Press firmly on the flare, ensuring that it is properly positioned. Using the bottom rear hole in the flare as a guide, drill a hole into the wheel well using a 5/16" drill bit.

9. REAR FLARE INSTALLATION - CONTINUED

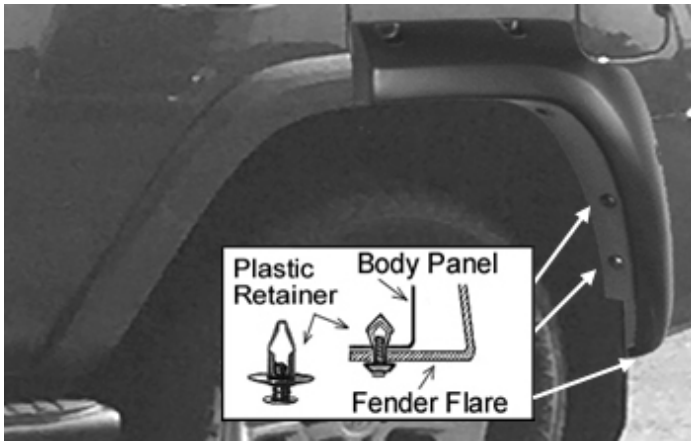

1. Insert 3 plastic retainers through the holes in the flare and into the wheel well in the locations shown.
2. Ensure that the flare is properly positioned and tighten all screws.

10. REAR FLARE INSTALLATION - CONTINUED



1. Place the door panel on the proper location of the door and trace with a grease pencil or mask the outline of the top edge of the panel on the door..
2. Familiarize yourself with the location of the 3M adhesive strips on the backside of the door panel piece. With an alcohol based cleaner, wipe clean and dry the door section inside of the outline.
3. Once dry, use a 3M promotor pad to wipe the surface area where the 3M adhesive strips will contact the door. Allow to dry.

9. REAR FLARE INSTALLATION - CONTINUED

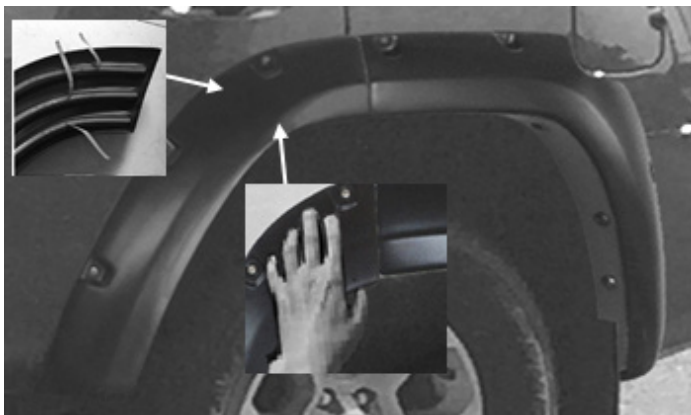

1. Remove the red backing of the 3M adhesive strips ONLY enough to stick outside of the edges of the door panel, as shown.
2. Using your outline as a guide, align the door panel carefully with the door edge and gap between the main flare, making sure there is proper clearance. Press the door panel down over the factory flare.
3. Once in place, proceed to pull out the remainder of the red 3M adhesive backing and firmly press the door panel against the vehicle ensuring solid adhesion.

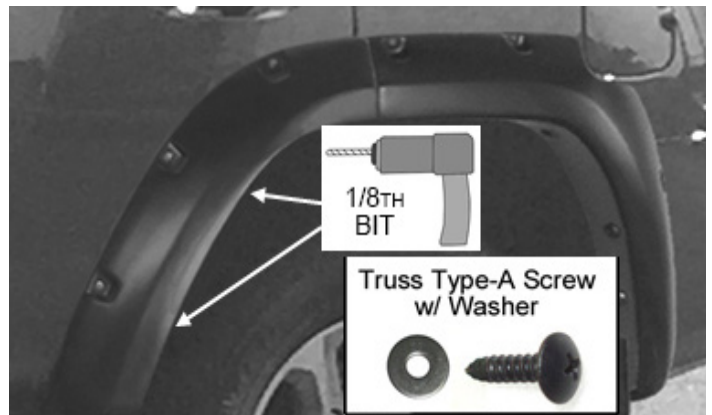

1. With a helper, hold the door panel firmly in place and use a 1/8" drill bit to drill 2 holes through the lip of the door panel and into the door.
2. Insert 2 truss type-A screws with washers into the holes and tighten securely.
3. Repeat steps 7-10 on the passenger side.

FOLLOW US!!

**BE SURE TO FOLLOW US & TAG US IN YOUR PICTURES FOR
A CHANCE TO WIN A 100% REBATE OF YOUR PURCHASE!
A NEW WINNER DRAWN EVERY MONTH!!**



@RDJ_TRUCKS



@RDJTRUCKS