



PRO-OFFROAD Bolt-On Style Fender Flares PRO-X-TEND Streamline Style Fender Flares

Installation Instructions - Toyota Tacoma 2016-2021

Part# 10-6014 (PRO-OFFROAD) / 25-6014 (PRO-X-TEND)

ATTENTIONATTENTION***ATTENTION*** YOU MUST READ THE FOLLOWING POINTS BEFORE PROCEEDING WITH ANY STEP OF INSTALLATION

1. Inspect your fender flares for shipping damage immediately upon receipt. Shipping damage must be reported within 48 hours of receipt.
2. Test fit all flare pieces to your vehicle before beginning any other step to confirm you have received the correct set of fender flares for your application. Ensure that all pieces in the parts list below are present.
3. While professional installation is always recommended, RDJ Trucks fender flares can be installed by handy individuals with the proper tools. However, it is a 2-man job. Attempting to achieve a proper fit on one's own is highly discouraged.
3. Due to the tolerances allowed by the motor companies during the assembly of the vehicles, some adjustments or modifications may be necessary to achieve a proper fit.
4. PAINTING - All inspections and test fittings must be made prior to painting the fender flares. No claim of damage, fitment or other defects/errors may be made after painting has occurred. RDJ Trucks is not liable for any costs incurred from painting and/or associated labor.
5. *****2016-2020 TACOMA - POCKET BOLTS INSTALLED AROUND THE PERIMETER OF THE FLARES ARE FOR DECORATION ONLY** and are NOT used in mounting the fender flares to the vehicle. The existing holes in the fenders of your Tacoma are NOT used in installation. The pocket holes in the fender flares are NOT intended to line up to the existing holes in your fenders. The decorative pocket bolts are NOT intended to reach through the existing holes and are supposed to stop short of reaching the fenders of the truck.

PARTS LIST



802-0910LF
803-0910LF
LEFT FRONT
& BRACKET



802-0910RF
803-0910RF
RIGHT FRONT
& BRACKET



802-0910LR
803-0910LR
LEFT REAR



802-0910RR
803-0910RR
RIGHT REAR



R0300
(316")



U-CLIP
4 PCS



WASHER
HEAD SCREW
28 PCS



SELF-TAPPING
SCREW
10 PCS

FOR PRO-OFFROAD VERSION ONLY



ALLEN BOLT
34 PCS



NYLON NUT
34 PCS



WASHER
34 PCS



TORX BIT
1 PC



Watch the installation
& review video by



<https://youtu.be/9-lg7dR-sY8>



1. RUBBER WEATHER SEAL APPLICATION

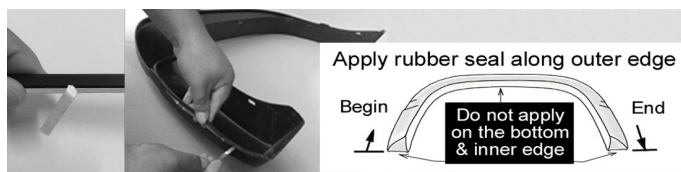

1. Thoroughly clean inside top edge of each flare (where the 3M adhesive will touch) with an alcohol based cleaner.
2. Do not peel the red backing off of the 3M adhesive until instructed. Beginning with the first flare, apply the rubber weather seal in roughly 1 foot sections at a time. From the starting end, leave an extra 1 inch of trim off of the end of the flare so that you can grab and peel the red adhesive backing.
3. With roughly 1 foot of trim applied to the edge, peel the red adhesive backing, pulling it out a few inches at a time. At the same time, press trim firmly in place, ensuring that it is securely adhered to the edge of the flare.
4. Continue the same process in 1 foot sections until the trim is firmly adhered to the entire outer edge of the flare. With a razor knife, cut off the excess trim from each end of the flare.
5. Repeat process for remaining flares.

2. POCKET BOLT APPLICATION

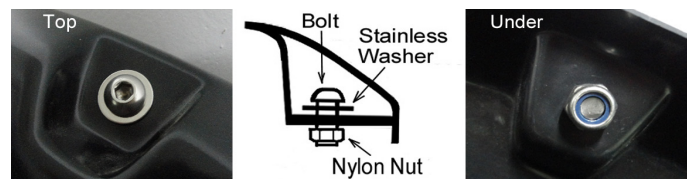

1. Apply washer to allen bolt and insert allen bolt into each pocket hole. *NOTE: Washer should be on the outside of the flare underneath the allen bolt head, NOT on the backside under the nylon nut.
2. Apply nylon nut to allen bolt and tighten carefully. Do not overtighten.
3. Repeat for each pocket.

3. FRONT FLARE - OE FLARE REMOVAL (DRIVER)



1. Remove 3 existing screws from the mud flap. Save screws for re-installation (See diagram). Remove mud flap.
2. Remove 5 existing screws from the flare lip.
3. Carefully pull OE flare away from the vehicle, separating the 3M adhesive.
4. Use an adhesive remover product, such as 3M Adhesive Remover, to remove the remaining adhesive from the fender.

4. FRONT FLARE - EXISTING HARDWARE REMOVAL

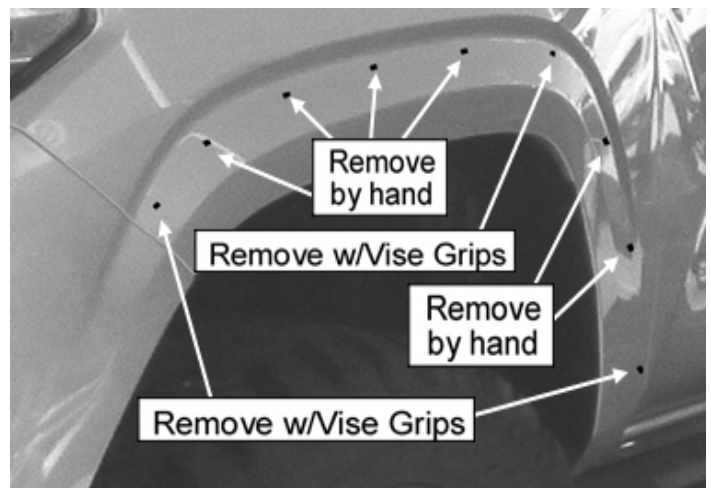

1. Remove 6 OE clips from the fender by hand, twisting to release.
2. Remove 3 OE clips from the fender with vise grips as shown in diagram.

5. FRONT FLARE - BRACKET INSTALLATION

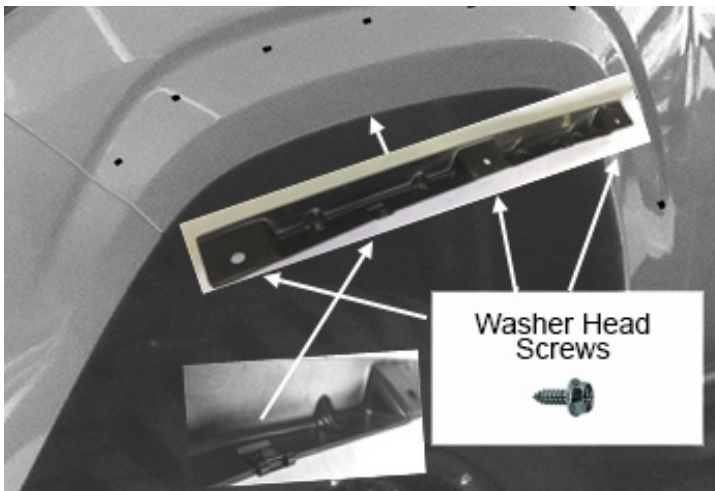

1. Make sure to have the driver side bracket (LF). Test fit in the wheel well to become familiar with proper installation location.
2. Apply 2 u-clips over 2 holes as shown in the diagram.
3. Aligning the bracket in the top of the wheel well, insert 3 washer head screws through the bracket and into existing holes in the wheel well.

6. FRONT FLARE - FLARE INSTALLATION (DRIVER)

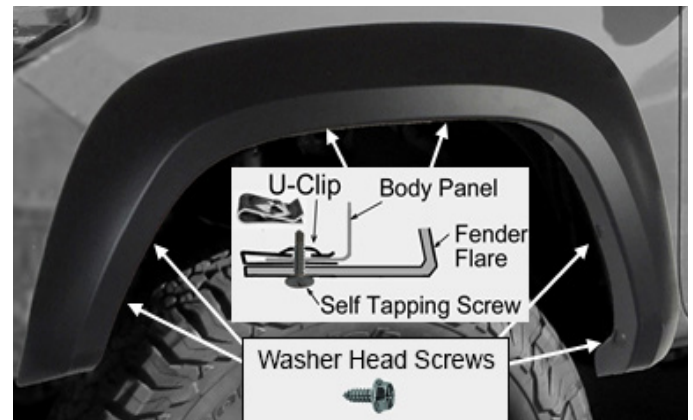

1. With a helper, hold the flare firmly in place on the vehicle, adjusting as necessary to achieve a flush, proper fit. Align 2 holes on the top of the flare with the 2 u-clips applied to the bracket in step 5.
2. Insert 2 supplied self-tapping screws through the flare and into the u-clips.
3. Insert 4 supplied washer head screws through the flare and into the existing holes in the wheel well as shown in the diagram.
4. Ensure that the flare is positioned properly and tighten all screws. Repeat steps 3-6 on the passenger side.

7. REAR FLARE - OE FLARE REMOVAL (DRIVER)

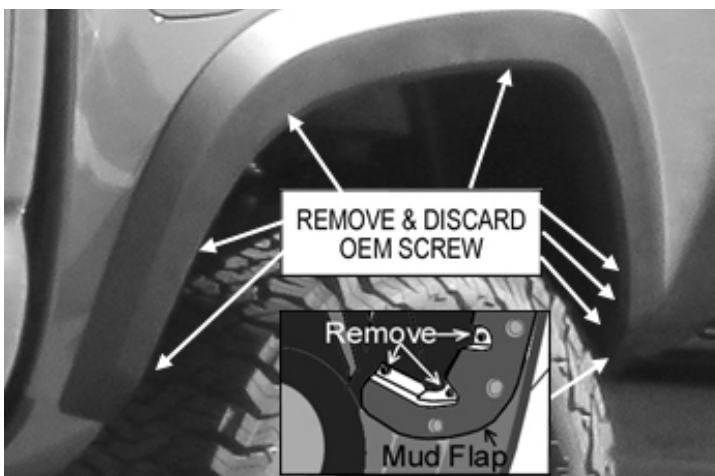

1. Remove 3 existing screw from the mud flap and save for re-installation. Remove the OE mud flap.
2. Remove 7 existing screws and carefully pull the OE flare away from the vehicle, separating the 3M adhesive.
3. Use an adhesive remover product, such as 3M Adhesive Remover, to remove the remaining adhesive from the fender.

8. REAR FLARE - EXISTING HARDWARE REMOVAL

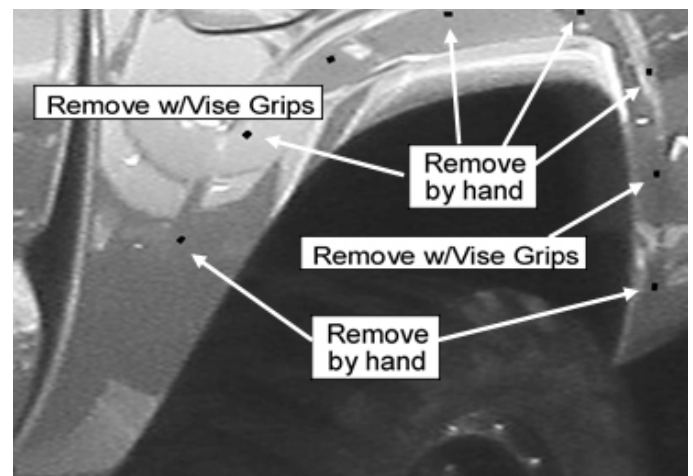

1. Remove 6 OE clips from the fender by hand, twisting to release.
2. Remove 2 OE clips from the fender with vise grips as shown in the diagram.

9. REAR FLARE - FLARE INSTALLATION (DRIVER)

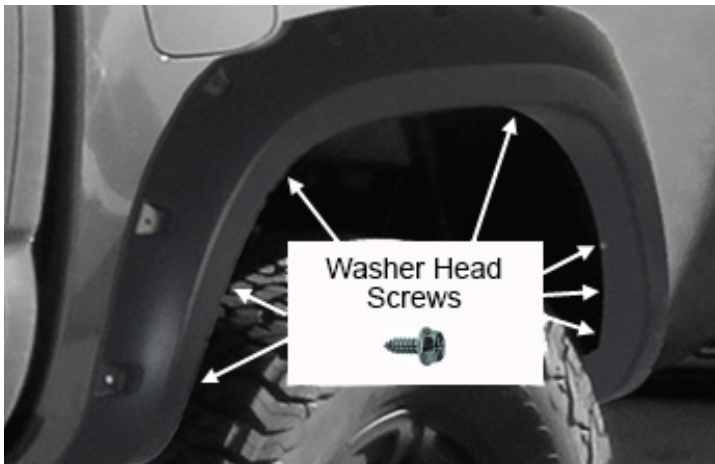

1. With a helper, hold flare firmly in the proper position making sure that the top edge is flush against the fender.
2. Insert 7 supplied washer head screws through the flare and into the existing holes in the fender well.
3. Ensure that the flare is properly positioned and tighten all screws. Repeat steps 7-9 on the passenger side.

10. FINAL INSPECTION

1. Due to the tolerances allowed by the motor companies during assembly of the vehicle, adjustments may be necessary to work out any gaps that may occur and ensure a proper, flush fit.
2. Supplied self-tapping screws may be inserted in any location that is in need of additional support. With a helper holding the flare flush against the fender of the truck, insert self-tapping screws through the inner lip of the flare and into fender well wall. Repeat as needed.
3. Check rubber weather seal to ensure a proper seat. Make sure that the top edge of the rubber weather seal is not folded under, behind the flare at any point.
4. If needed, use the supplied seal tool (hooked edge) to properly seat the seal, sliding it along the weather trimmed edge of the flare.



**BE SURE TO FOLLOW US & TAG US IN YOUR PICTURES FOR
A CHANCE TO WIN A 100% REBATE OF YOUR PURCHASE!
A NEW WINNER DRAWN EVERY MONTH!!**



@RDJ_TRUCKS



@RDJTRUCKS

ALSO AVAILABLE

**TRAVELPRO 65-SERIES
HARD FLIP TRI-FOLD TONNEAU COVER**