



HWY-PRO Factory/OEM Style Fender Flares

Installation Instructions - Toyota Tundra 2007-2013

Part# 40-6015

ATTENTION ATTENTION *** ATTENTION *** YOU MUST READ THE FOLLOWING POINTS BEFORE PROCEEDING WITH ANY STEP OF INSTALLATION

1. Inspect your fender flares for shipping damage immediately upon receipt. Shipping damage must be reported within 48 hours of receipt.
2. Test fit all flare pieces to your vehicle before beginning any other step to confirm you have received the correct set of fender flares for your application. Ensure that all pieces in the parts list below are present.
3. While professional installation is always recommended, RDJ Trucks fender flares can be installed by handy individuals with the proper tools. However, it is a 2-man job. Attempting to achieve a proper fit on one's own is highly discouraged.
3. Due to the tolerances allowed by the motor companies during the assembly of the vehicles, some adjustments or modifications may be necessary to achieve a proper fit.
4. PAINTING - All inspections and test fittings must be made prior to painting the fender flares. No claim of damage, fitment or other defects/errors may be made after painting has occurred. RDJ Trucks is not liable for any costs incurred from painting and/or associated labor.
5. Most importantly, we know that when it comes to choosing fender flares for your truck, you have a multitude of options. We are extremely grateful that you put your faith in our small company. If you experience any issues or if there is anything we can do to assist you, please don't hesitate to contact us - info@rdjtrucks.com

PARTS LIST



RUBBER EDGE TRIM INSTALLATION

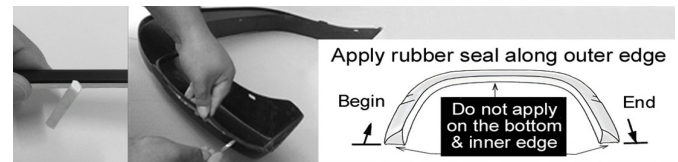

1. Thoroughly clean inside top edge of each flare (where the 3M adhesive will touch) with an alcohol based cleaner and allow to dry.
2. Do not peel the red backing off of the 3M adhesive until instructed. Beginning with the first flare, apply the rubber weather seal in roughly 1 foot sections at a time. From the starting end, leave an extra 1 inch of trim off of the end of the flare so that you can grab and peel the red adhesive backing.
3. With roughly 1 foot of trim applied to the edge, peel the red adhesive backing, pulling it out a few inches at a time. At the same time, press trim firmly in place, ensuring that it is securely adhered to the edge of the flare.
4. Continue the same process in 1 foot sections until the trim is firmly adhered to the entire outer edge of the flare. With a razor knife, cut off the excess trim from each end of the flare.
5. Repeat process for remaining flares.

1. FRONT FLARE INSTALLATION - DRIVER SIDE

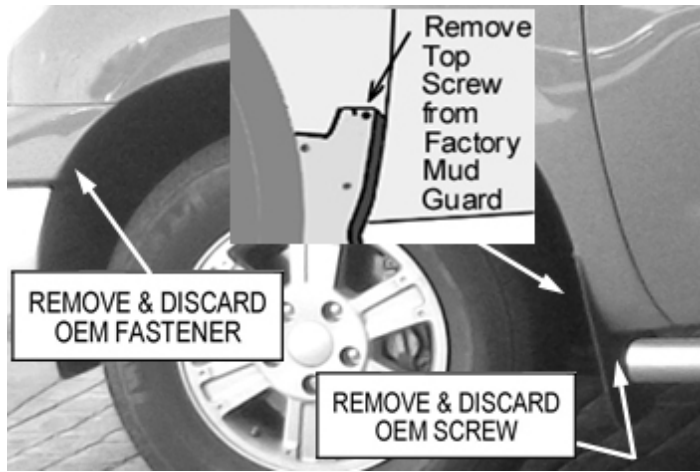

1. Remove and discard the existing OEM fastener at the forward position of the fender well.
2. Locate, remove and discard the existing OEM fastener from the top of the factory mud flap as shown. If factory mud flaps are not installed, make sure that there is no fastener in this hole as it will be used for securing the flare later.
3. Remove and discard the existing OEM fastener from the bottom of the factory mud flap. If factory mud flaps are not installed, make sure that there is no fastener in this hole as it will be used for securing the flare later.

2. FRONT FLARE INSTALLATION - CONTINUED

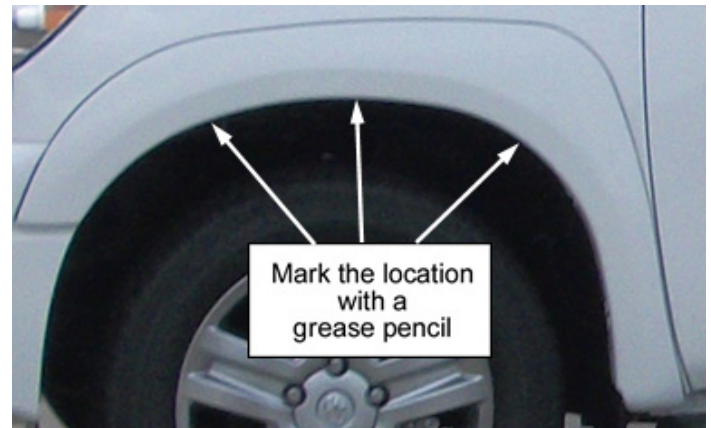

1. With a helper, place the left side front flare firmly in position on the fender, making sure that it is flush and properly aligned to the body.
2. Using a grease pencil, mark the fender lip at each of the 3 upper hole locations in the flare.
3. Remove the flare from the vehicle.

3. FRONT FLARE INSTALLATION - CONTINUED

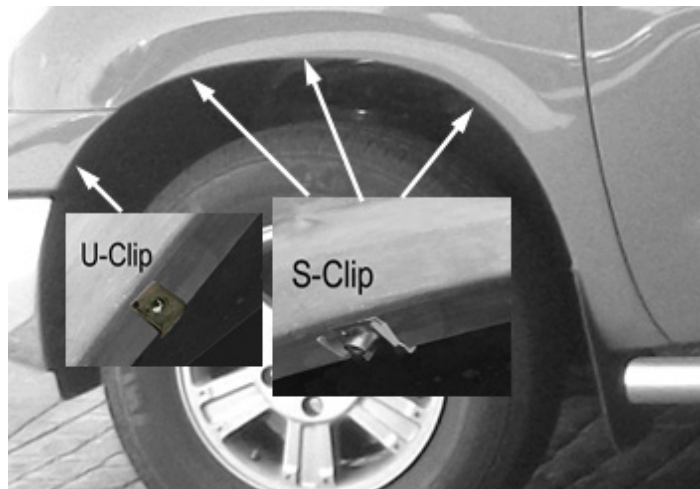

1. Apply 1 U-clip over the existing hole in the fender lip at the forward location shown.
2. Apply 3 S-clips over the fender lip at the locations marked in the previous step.

4. FRONT FLARE INSTALLATION - CONTINUED

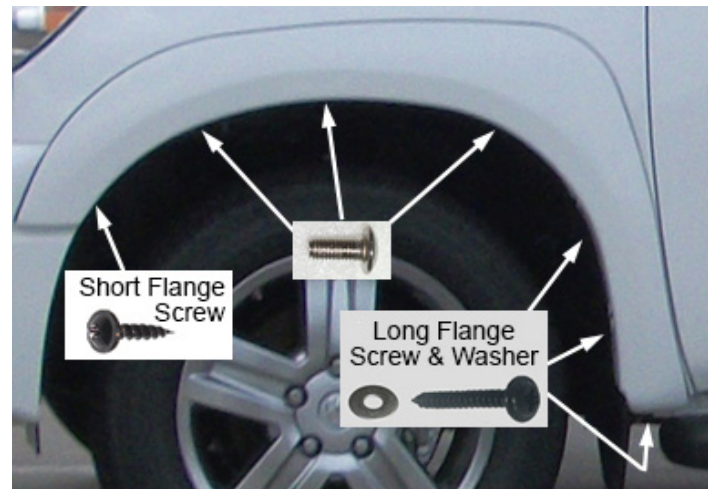

1. With a helper, place the flare on the fender, firmly in position, sliding the rear of the flare behind the mud flap, if installed.
2. Insert 3 truss screws into the S-clips under the upper 3 hole locations. Do not fully tighten yet.
3. Insert a short flange screw into the U-clip under the forward hole location as shown. Do not fully tighten yet.
4. Insert 2 long flange screws with washers into the rearward holes and one underneath into the bottom hole. Do not fully tighten yet.
5. Make sure the flare is properly positioned on the fender. With a helper holding the flare in that position, proceed to tighten each screw.
6. Repeat steps 1-4 on the passenger side.

5. REAR FLARE INSTALLATION - DRIVER

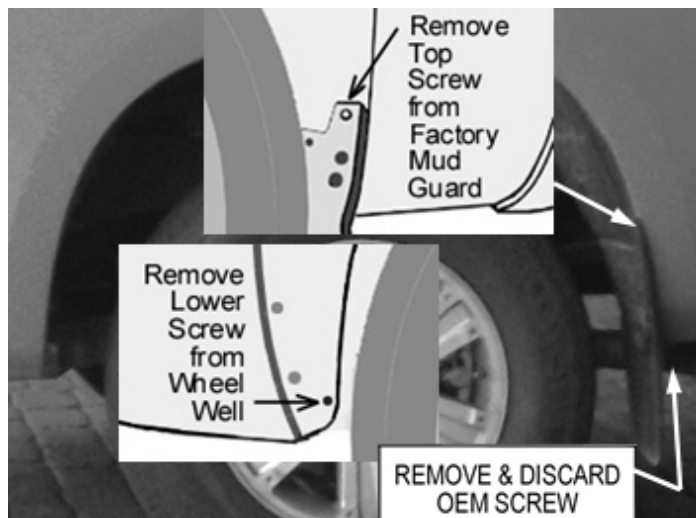

1. Locate, remove and discard the existing OEM fastener from the top of the factory mud flap as shown. If factory mud flaps are not installed, make sure that there is no fastener in this hole as it will be used for securing the flare later.
2. Remove and discard the existing OEM fastener from the bottom forward position of the wheel well as shown bottom left.
3. Remove and discard the existing OEM fastener from the bottom of the factory mud flap. If factory mud flaps are not installed, make sure that there is no fastener in this hole as it will be used for securing the flare later.

7. FINAL INSPECTION

1. Due to the tolerances allowed by the motor companies during assembly of the vehicle, adjustments may be necessary to work out any gaps that may occur and ensure a proper, flush fit.
2. Supplied self-tapping screws may be inserted in any location that is in need of additional support. With a helper holding the flare flush against the fender of the truck, insert self-tapping screws through the inner lip of the flare and into fender well wall. Repeat as needed.
3. Check rubber weather seal to ensure a proper seat. Make sure that the top edge of the rubber weather seal is not folded under, behind the flare at any point. If necessary, use the seal tool properly seat the rubber weather seal.



6. REAR FLARE INSTALLATION - CONTINUED

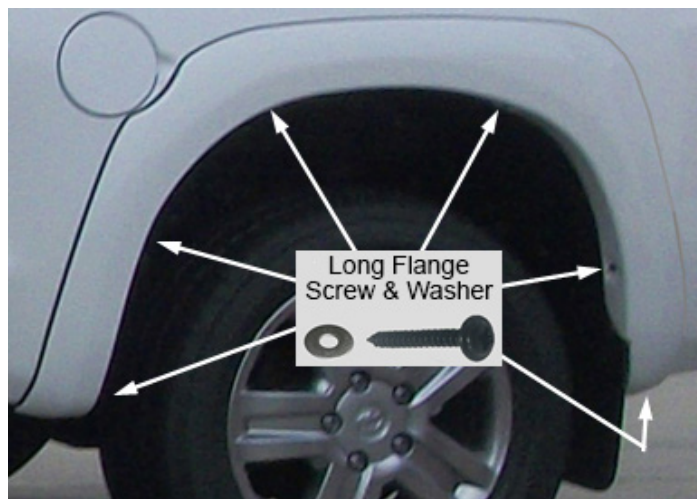

1. With a helper, place the flare on the fender, firmly in position, sliding the rear of the flare behind the mud flap, if installed.
2. Insert 6 long flange screws with washers into the hole locations as shown. Do not fully tighten yet.
3. Once all screws are in place, have a helper hold the flare firmly flush against the fender and in the proper position, then tighten each screw.
4. Repeat steps 5-6 on the passenger side.

DON'T FORGET

ABOUT OUR 65-SERIES TONNEAU COVERS

**TRI-FOLDING HARD-FLIP STYLE
INSTALL AND REMOVE IN LESS THAN 10 MINUTES!**

FOLLOW US & WIN!!

**BE SURE TO FOLLOW US & TAG US IN YOUR PICTURES FOR
A CHANCE TO WIN A 100% REBATE OF YOUR PURCHASE!
A NEW WINNER DRAWN EVERY MONTH!!**



@RDJ_TRUCKS



@RDJTRUCKS