

RDJ TRUCKS

Make & Model

TOYOTA TUNDRA 2014-2019

FENDER FLARE INSTALLATION INSTRUCTION

Item No. 40-6016

HWY-PRO OE STYLE FENDER FLARES

Parts A - Flares & Rubber Strip

800-0904LF L. Front Flare & Bracket 1 pc/ea	800-0904RF R. Front Flare & Bracket 1 pc/ea	800-0904LR Left Rear Flare 1 pc	800-0904RR Right Rear Flare 1 pc	R0300 Rubber Seal 1 roll(324")	T1193 Seal Tool 1 pc

Parts B - Parts for Installation

C2013 U-Clip 4 pcs	S0414 Flang Type-A Screw 4 pcs	S0620 Truss Type-A Screw 30 pcs	W0616 Washer 30 pcs	P0800 Plastic Retainer 4 pcs	S0432 Self Tapping Screw 8 pcs

Caution: Always check the package, ensure the fitment of fender flare and follow the instruction carefully. PSI will not be responsible for painting & other cost incurred to incorrect fender flares, failure of installation, shipping damage or modified flares.

1. Pre-Installation



1. Prefit and ensure both left (driver) side & right (passenger) side fender flare to the vehicle before painting or installation.
2. You may remove any moldings, strips or existing flares from the vehicle for fitting and installation.

3. Clean Vehicle Body & Fender Flare

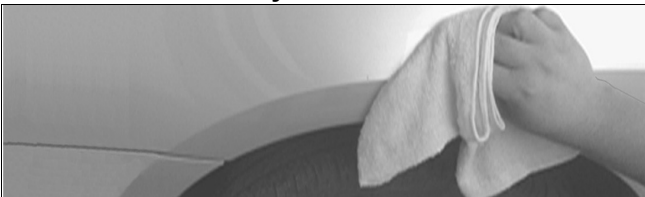

1. Wash and wipe dry the areas of contact on the vehicle body.
2. Clean the surface and inside edge of the fender flare where the rubber seal is to be attached.

5. Installation (Left Front Flare Shown)

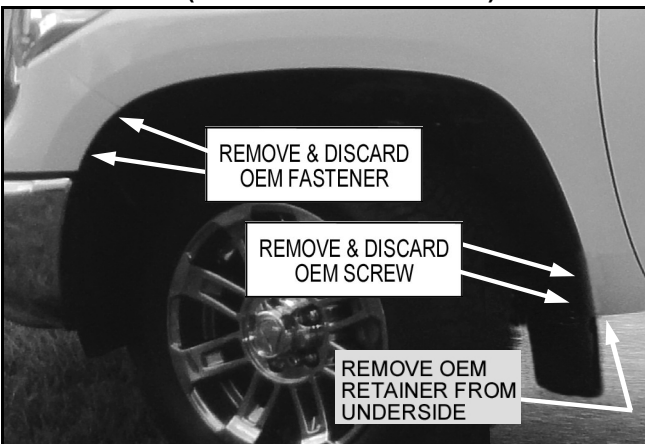

1. Remove 2 factory fasteners from front wheel well.
2. Remove 2 factory screws from factory mud guard.
3. Remove a push-in retainer from underside of the mud guard,
4. Remove the factory mud guard.

2. Paint Flare(Optional)

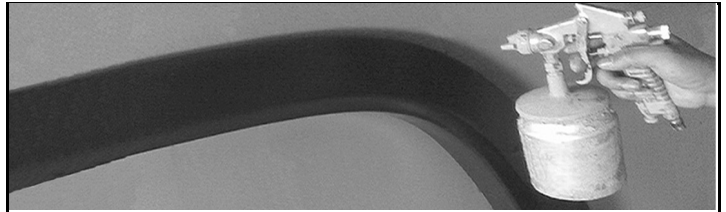

1. Hire a professional painter or body shop and follow the paint manufacturer specifications to paint the flares.
2. Clean all fender flare surface with clean water & a mild detergent before paint, don't use lacquer thinner or any solvent based product

4. Apply Rubber Seal

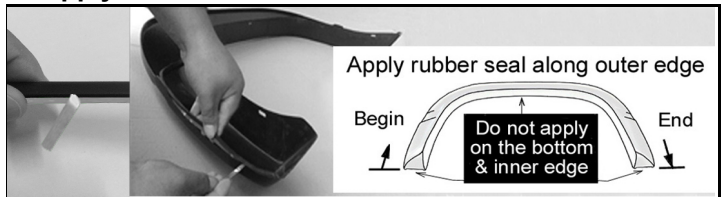

1. Remove 1 inch tape liner from rubber seal, apply it on the flare, start one end & along the edge that comes in contact with body panel. **Caution: 3M tape will be sticked on the inside of the flare.**
2. Make sure the rubber seal along the edge well, rip the tape liner off gradually, apply pressure on the tape in the same time to ensure that it be adhesied well. Trim excess rubber seal and so on.

6. Installation (Left Front Flare Shown)

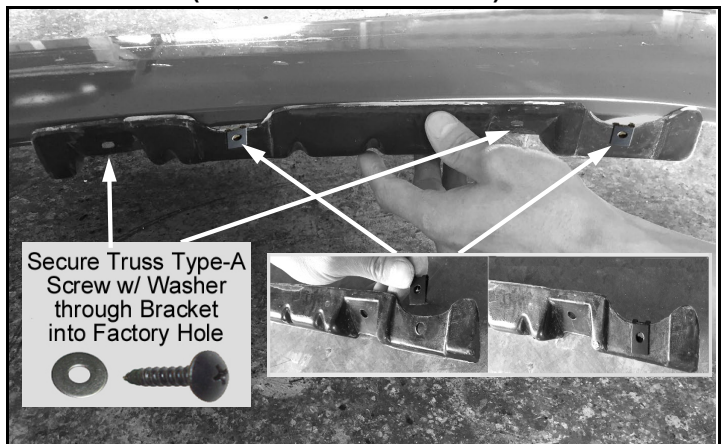

1. Apply 2 U-Clips on the bracket as right shown.
2. Secure 2 supplied Truss Type-A screws with washer through the holes on the bracket into the factory holes.

7. Installation (Left Front Flare Shown)

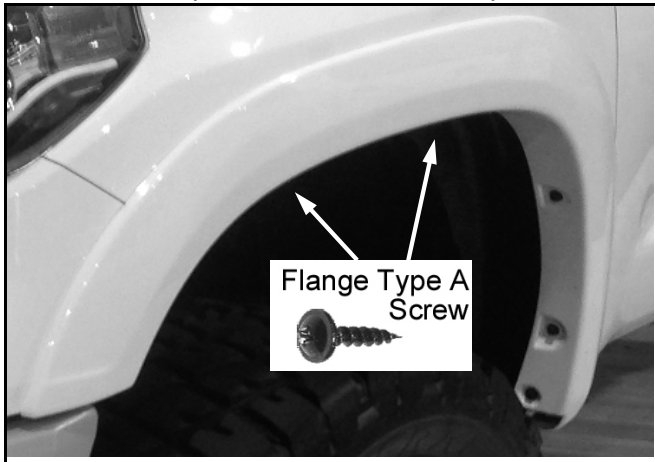

1. Place the flare on fender in right **position**, aligning two holes on the top of flare with clips on the bracket that apply on the step 6.
2. Apply 2 supplied **Flange Type-A screws** with washer through two holes on flare, and into U-Clips.

9. Installation (Left Rear Flare Shown)

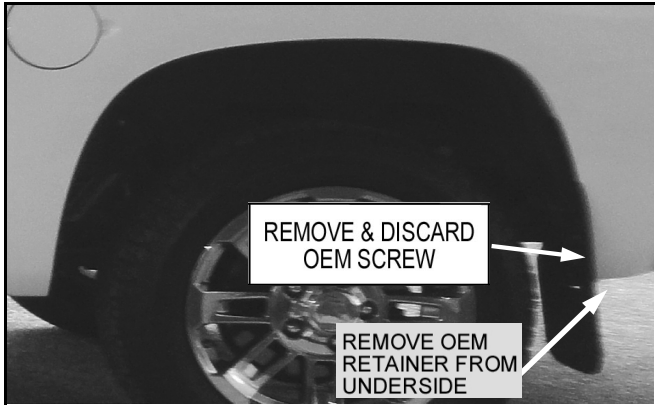

1. Remove factory screw from factory mud guard.
2. Remove a push-in retainer from underside of the mud guard,
3. Remove the factory mud guard.

11. Installation (Left Rear Flare Shown)

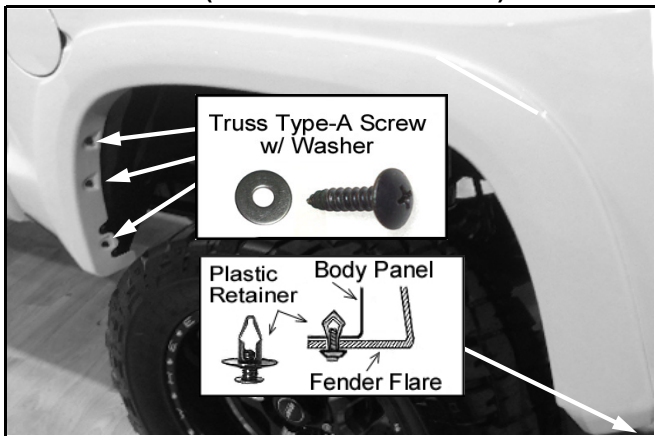

1. Apply 3 Truss Type-A screws with washer through 3 holes in the most front of flare, into the factory holes on the wheel well.
2. Install the retainer into factory hole on underside of flare.
3. Ensure the flare is on the proper position, tighten all screws.

8. Installation (Left Front Flare Shown)

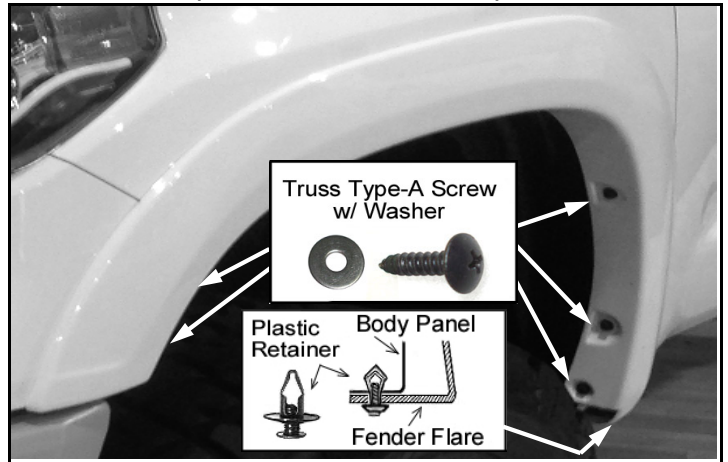

1. Apply 3 supplied Truss Type-A screws with washer through three holes in the rear of flare, & into the factory holes on the wheel well.
2. Apply 2 supplied Truss Type-A screws with washer through two holes in the most of flare, & into the factory holes on the wheel well.
3. Install the retainer into factory hole on underside of flare.
4. Ensure the flare is on the proper position, and tighten all screws.

10. Installation (Left Rear Flare Shown)

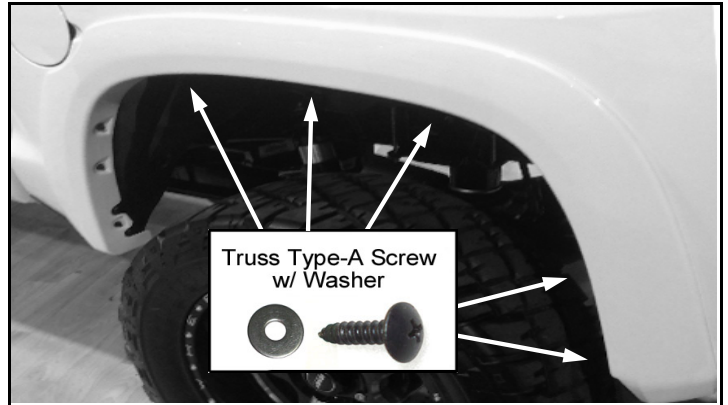

1. Hold the flare firmly, apply 3 Truss Type-A screws with washer through three holes in the top of flare, and into the factory holes on the wheel well.
2. Apply 2 Truss Type-A screws with washer through two holes in the most rear of flare, and into the factory holes on the wheel well.

12. Installation (All Flare Shown)

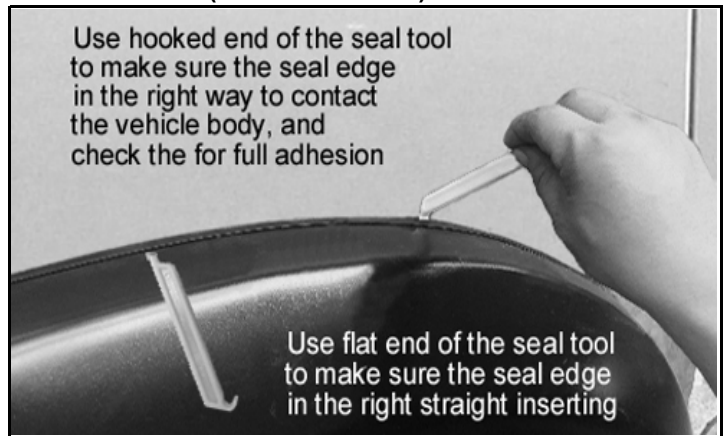

1. You may skip this step if you have right seal installation on step 4. and right flare applying on each.
2. Use hooked end of the seal tool to make sure the seal edge in the right way to contact the vehicle body, sliding it along full edge. Use the the flat end of the seal tool to make sure the seal edge in the right strait inserting, do it along full edge.

Optional : The included self tapping screw may be used for extra secure if it need to be.